

Instrument Classification

Each Beckman Coulter preparative ultracentrifuge carries a safety classification that defines which Beckman Coulter rotors may be safely operated in that centrifuge. The letter classifications (from A to T) take into account rotor energies, size of the rotor chamber, and instrument updates. The classification is indicated on a decal which should be above the rotor chamber opening on the top of your instrument or on the chamber door. If this decal is missing or you are unsure of your ultracentrifuge's correct classification, please call your local Beckman Coulter Service Engineer for assistance. Instruments currently being manufactured are classified as H, R, or S.

Before ordering a rotor, check the decal on your instrument to make certain it will accommodate the rotor selected. The Optima™ L series ultracentrifuges that are classified "S" and the L8 and L8M series ultracentrifuges can spin all* Beckman Coulter preparative ultracentrifuge rotors. Other instruments have lower classifications and the number of rotors which may be used is fewer. Each rotor listing on the following pages indicates the instrument classifications in which they can be used.

Beckman Coulter rotors and ultracentrifuges are designed and tested as complete systems, and engineered for safe, reliable operation. We do not test Beckman Coulter rotors in non-Beckman Coulter ultracentrifuges, nor non-Beckman Coulter rotors in Beckman Coulter ultracentrifuges. It is not recommended that Beckman Coulter rotors be used in other instruments or that rotors made by other manufacturers be used in Beckman Coulter ultracentrifuges.

Speed Reductions

When using any rotor, be sure to observe the instructions given in the appropriate Rotor Manual. Speed limitations lower than those given in this Product Selection Guide may be required because of weight considerations—the weight of a tube, a cap, or the density of the solution being centrifuged. Other considerations, such as the precipitation of cesium salt, require deration of the rotor as well. Use the equations of the CsCl deration curves given in the Rotor Manual to determine the correct rotor speed. If a Rotor Manual has been lost, contact your local Beckman Coulter office to request a replacement.

Preparative Floor Model Rotor Designations

All fixed-angle preparative floor model ultracentrifuge rotors are designated by the word Type, vertical-tube rotors by the symbol VT, near-vertical by the symbol NVT™, and swinging bucket rotors by the symbol SW. The symbol Ti means the rotor is made of titanium. The one exception is the Z-60 which is also a titanium rotor. All other rotors are made of aluminum.

* Except Type 15 rotors.

k Factors

The k factors shown in the rotor charts can be used to compare the efficiency of various rotors for the material that will be centrifuged. They are a guide to the time, t (in hours), required to pellet a particle of known sedimentation coefficient, s (in Svedberg units): $t=k/s$.

Centrifugal Forces

The centrifugal forces given for rotors in these publications have been rounded to three significant figures using the formula

$$g = 1.12r \left(\frac{\text{rpm}}{1000} \right)^2, \text{ RPM} = \sqrt{\frac{\text{RCF}}{1.12r}}$$

where r is the radius in millimeters.

Tube Kits

For your ordering convenience, most Beckman Coulter Fixed-Angle Rotors are sold as Rotor Assemblies with a choice of Tube Kits. For rotors that accommodate OptiSeal™ and Quick-Seal® tubes, you can order kits with these tubes instead of a Rotor Package with capped tubes only. Each kit comes complete with up to 200 tubes, the appropriate number of cap assemblies or spacers, Vacuum Grease, and, in the case of the OptiSeal and Quick-Seal Kits, a Tube Rack. For complete ordering information, see the individual rotor listings that follow.

Use of Small Tubes

With the use of appropriate spacers and/or adapters, many rotors can accommodate tubes smaller than the tube cavities. When centrifuging small samples, use of these smaller tubes increases the efficiency and speeds the process. A chart of compatible tubes is provided with each rotor listing.

Innovative g-Max™ System

The g -Max system adds valuable capabilities to your Beckman Coulter ultracentrifuge rotors. Based on a unique approach to tube support within the rotor cavities, the system lets you run smaller volumes in Fixed-Angle, Vertical-Tube and Swinging Bucket Rotors with no reduction in g -force and at lower k factors to achieve separations in much shorter run times.

This system uses patented Beckman Coulter Quick-Seal bell-top tubes and floating spacers. Unlike conventional sleeve-type adapters, the g -Max spacers "float" on top of the tube which keeps the sample at the maximum radius of the tube cavity.

Note: To help you locate g -Max tubes in the rotor listings, these tubes are highlighted with bold, italic type. To make it easy to order these tubes the first time, g -Max kits are available which include enough spacers to completely fill the rotor, as well as 50 Quick-Seal polyallomer tubes and two tools (one for spacer removal and one for tube removal). These kits are also listed.

Quick-Reference Guide to Instrument Classification Rotor Compatibility

Beckman Coulter no longer offers rotors containing the required safety features that would allow them to operate in the following obsolete Ultracentrifuge Models: L, L2-50, L2-65, L2-65/75, L3-40/50, L4, L5, and L5B. Rotors are no longer available with mechanical overspeed devices for the following ultracentrifuges: L, L2-50, L3-40, L3-50, L5-30, and L5-40.

All ultracentrifuges with the following classifications are obsolete and no longer supported with replacement parts or service from Beckman Coulter: A, B, C, D, E, F, G, Q, and some L5/L5B instruments classified as H. The L5B is the newest of these and was last manufactured in 1983. Please contact your Beckman Coulter Sales/Service organization for assistance with any of these models.

Rotor	L7	L8/L8M	Optima™ L/LE	
	R	H	R	S
Type 100 Ti	●	●	●	●
Type 90 Ti	●	●	●	●
Type 80 Ti	●	●	●	●
Type 75 Ti	●	●	●	●
Type 70 Ti	●	●	●	●
Type 70.1 Ti	●	●	●	●
Type 65	●	●	●	●
Type 60 Ti	●	●	●	●
Type 55.2 Ti	●	●	●	●
Type 50 Ti	●	●	●	●
Type 50.2 Ti	●	●	●	●
Type 50.3 Ti	●	●	●	●
Type 50.4 Ti	●	●	●	●
Type 50	●	●	●	●
Type 45 Ti	●	●	●	●
Type 42.2 Ti	●	●	●	●
Type 42.1	●	●	●	●
Type 40.3	●	●	●	●
Type 40.2	●	●	●	●
Type 40	●	●	●	●
Type 35	●	●	●	●
Type 30.2	●	●	●	●
Type 30	●	●	●	●
Type 28	●	●	●	●
Type 25	●	●	●	●
Type 21	●	●	●	●
Type 19	●	●	●	●
Type 16	●	●	●	●
NVT 100	●	●	●	●
NVT 90	●	●	●	●
NVT 65.2	●	●	●	●
NVT 65	●	●	●	●

Rotor	L7	L8/L8M	Optima™ L/LE	
	R	H	R	S
VTi 90	●	●	●	●
VTi 80	●	●	●	●
VTi 65.1	●	●	●	●
VTi 65.2	●	●	●	●
VTi 65	●	●	●	●
VTi 50	●	●	●	●
VC 53	●	●	●	●
VAC 50	●	●	●	●
SW 65 Ti	●	●	●	●
SW 60 Ti	●	●	●	●
SW 56	●	●	●	●
SW 55 Ti	●	●	●	●
SW 50.1	●	●	●	●
SW 41 Ti	●	●	●	●
SW 40 Ti	●	●	●	●
SW 50 L	●	●	●	●
SW 39 L	●	●	●	●
SW 36	●	●	●	●
SW 32.1 Ti	●	●	●	●
SW 32 Ti	●	●	●	●
SW 30.1	●	●	●	●
SW 30	●	●	●	●
SW 28.1	●	●	●	●
SW 28	●	●	●	●
SW 27.1	●	●	●	●
SW 27	●	●	●	●
SW 25.2	●	●	●	●
SW 25.1	●	●	●	●
CF-32 Ti		●		●
Ti-15		●		●
Ti-14		●		●

Beckman Coulter Floor Model Ultracentrifuge Rotors by Use

1

Rotors for Centrifuging Extremely Small Particles

Rotor	Max. rpm	Max. g	k Factor	No. of Tubes x Nominal Tube Volume (mL) ¹	Nominal Rotor Capacity (mL)	For Use in Instruments Classified
Type 100 Ti	100,000	802,000	15	8 x 6.8	54	HRS
NVT 100	100,000	750,000	8	13 x 5.1	40.8	RS
Type 90 Ti	90,000	694,000	25	8 x 13.5	108	HRS
NVT 90	90,000	645,000	10	8 x 5.1	40.8	HRS
VTi 90	90,000	645,000	6	8 x 5.1	40.8	HRS
Type 70.1 Ti	70,000	450,000	36	12 x 13.5	162	HRS
NVT 65	65,000	402,000	21	8 x 13.5	108	HRS
NVT 65.2	65,000	416,000	15	16 x 5.1	81.6	HRS
VTi 65.1	65,000	400,700	13	8 x 13.5	108	HRS
VTi 65.2	65,000	416,000	10	16 x 5.1	81.6	HRS

Rotors for Centrifuging Small Particles in Volume

Type 70 Ti	70,000	504,000	44	8 x 39	312	HRS
Type 55.2 Ti	55,000	340,000	64	10 x 39	390	HRS
Type 50.2 Ti	50,000	302,000	69	12 x 39	468	HRS
VTi 50	50,000	242,000	36	8 x 39	312	HRS
Type 45 Ti	45,000	235,000	133	6 x 94	564	HRS

Rotors for Differential Flotation

Type 50.4 Ti	50,000	270,000	39	44 x 6.5	286	HRS
Type 42.2 Ti	42,000	223,000	9	72 x 230	76.5	HRS
Type 25	25,000	92,500	62	100 x 1	100	HRS

Rotor for Concentrating Large Particles in Volume

Type 19	19,000	53,900	951	6 x 250	1500	HRS
---------	--------	--------	-----	---------	------	-----

Rotors for Isopycnic and Rate-Zonal Gradients

SW 60 Ti	60,000	485,000	45	6 x 4	24	HRS
SW 55 Ti	55,000	368,000	48	6 x 5.0	30	HRS
SW 41 Ti	41,000	288,000	124	6 x 13.2	79.2	HRS
SW 40 Ti	40,000	285,000	137	6 x 14	84	HRS

Rotor with Long, Slender Tubes for Rate-Zonal Gradients

SW 32.1 Ti	32,000	187,000	228	6 x 17	102	HRS
SW 28.1	28,000	150,000	276	6 x 17	102	HRS

Rotor for Larger-Volume Density Gradients

SW 32 Ti	32,000	175,000	204	6 x 38.5	231	HRS
SW 28	28,000	141,000	245	6 x 39	234	HRS

Continuous Flow and Zonal Rotors

Rotor	Max. rpm	Max. g	Capacity (mL)	Typical Sample Volume (mL) ¹	Size Range of Particles Separated (S)	For Use in Instruments Classified
CF-32 Ti	32,000	102,000	430	>1000	>50	HS
Ti-15	32,000	102,000	1,675	50-200	>100	HS
Ti-14	48,000	172,000	665	20-50	20-100	HS

¹ Smaller-volume tubes may also be used with adapters and/or spacers. Check the rotor listing for more information.

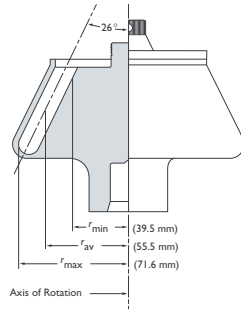

Fixed-Angle Rotor, Titanium

For use in instruments classified: **H R S**

Major applications: Rapid separation of plasmid DNA and rapid differential centrifugation of small particles.

Max. RPM	Max. g	k Factor	Number of Tubes Volume/Size	Rotor Capacity
100,000	802,000	15	8 x 6.8 mL ½ x 2 ½ in 13 x 64 mm	54 mL

No. **363013**. Type 100 Ti Rotor Assembly with 3 each 876089 O-rings, 3 each 839347 O-rings, and 2 each 363304 Overspeed Disks.

No. **363963**. Quick-Seal® Tube Kit with 4 boxes 344619 Polyallomer Tubes, 1 package 365470 Spacers, 1 each 361668 Tube Removal Tool, 306812 Spinkote™ Lubricant, and 335148 Vacuum Grease. (Cordless Tube Topper and Tube Rack required.)

Tubes and Bottles

Tube Style/Material	Part No.	Quantity	Vol. (mL) g-Max	Size (mm)	Required Caps/ Spacers (qty. 1)	Required Adapters (qty. 1)	g-Force	k Factor	Max. Speed
Quick-Seal	363650	50	6.8	13 x 64	362307	—	802,000	17.0	100,000
Polyallomer	344619	50	6.0	13 x 64	365470	—	802,000	15.0	100,000
	362248	50	5.1	13 x 51	360270	—	802,000	13.5	100,000
	363960*	50	5.1	13 x 51	360270	—	802,000	13.5	100,000
	349621	50	3.5	13 x 32	360270	—	802,000	9.4	100,000
	363961*	50	3.5	13 x 32	360270	—	802,000	9.4	100,000
	345829	50	2.0	13 x 25	360270	—	802,000	7.0	100,000
	363962*	50	2.0	13 x 25	360270	—	802,000	7.0	100,000

*To simplify ordering, this g-Max™ Kit includes enough spacers to fill rotor, 50 tubes, and required tools.

Note: To help you locate g-Max tubes in the rotor listings, these tubes are highlighted with bold, italic type.

Rotor Replacement Parts

- 839347 O-ring for Rotor Handle
- 363304 Overspeed Disk, 100,000 rpm
- 363039 Rotor Handle
- 876089 O-ring for Rotor Lid

Spacers (Package of 8)

- 365470 fits 13 x 57 mm
- 360270 fits 13 x 51 mm
- fits 13 x 30 mm
- fits 13 x 25 mm
- 362307 fits 13 x 64 mm

Adapters/Spacers/Caps

360270 362307 365470



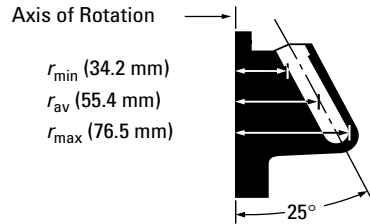

Fixed-Angle Rotor, Titanium

For use in instruments classified: **H R S**

Major applications: Five-hour separation of plasmid DNA and rapid differential centrifugation of small particles.

Max. RPM	Max. g	k Factor	Number of Tubes Volume/Size	Rotor Capacity
90,000	694,000	25	8 x 13.5 mL 5/8 x 3 in 16 x 76 mm	108 mL

No. 355530. Type 90 Ti Rotor Assembly with 3 each 839347 O-rings, 3 each 876089 O-rings, 2 each 355539 Overspeed Disks, and 356959 Tool.

No. 348179. Quick-Seal® Tube Kit with 2 boxes 342413 Polyallomer Tubes, 2 boxes 344322 Ultra-Clear™ Tubes, 12 each 342695 Spacers, 306812 Spinkote™ Lubricant, and 335148 Vacuum Grease. (Cordless Tube Topper Kit and Tube Rack required; see Tools, Accessories, and Supplies.)

No. 348180. Open-Top Tube Kit with 2 boxes 326814 Polyallomer Tubes, 2 boxes 344085 Ultra-Clear Tubes, 12 each 341968 Tube Caps, and 1 each 306812 Spinkote Lubricant, and 1 each 335148 Vacuum Grease. (331202 and 305075 Tools required; see Tools, Accessories, and Supplies.)

No. 361660. OptiSeal™ Tube Kit with 4 boxes of OptiSeal Tubes 361623, 12 Spacers 361670 (6 pkg. of 2), 1 OptiSeal Tube Rack 361642, 1 Tube Extraction Tool 361668, and 1 Spacer Removal Tool 338765.

Tubes and Bottles

Tube Style/Material	Part No.	Quantity	Vol. (mL) g-Max	Size (mm)	Required Caps/ Spacers (qty. 1)	Required Adapters (qty. 1)	g-Force	k Factor	Max. Speed
OptiSeal Polyallomer	361623	56	8.9	16 x 60	361670 ^a	—	694,000	21	90,000
Quick-Seal Polyallomer	342413	50	13.5	16 x 76	342695	—	694,000	25	90,000
	344622	50	10.0	16 x 67	344676	—	694,000	21	90,000
	345830	50	6.3	16 x 45	345828	—	694,000	14	90,000
	357334 ^b	50	6.3	16 x 45	345828	—	694,000	14	90,000
	356562	50	4.2	16 x 38	345828	—	694,000	11	90,000
	357332 ^b	50	4.2	16 x 38	345828	—	694,000	11	90,000
Quick-Seal Ultra-Clear	344322	50	13.5	16 x 76	342695	—	694,000	25	90,000
Polycarbonate Bottle/Assembly	355603 ^c	6	10.4	16 x 76	—	—	362,000	48	65,000
	355651 ^d	6	10.4	16 x 76	—	—	362,000	48	65,000
Thinwall Polyallomer	326814	50	13.5	16 x 76	341968	—	548,000	32	80,000
	326820	50	6.5	13 x 64	346256	303313	197,000	69	50,000
Thickwall Polyallomer	355640	25	10.0	16 x 76	338907	—	77,000	190	30,000
	355644	25	4.0	13 x 64	—	303313	197,000	69	50,000
Thickwall Polycarbonate	355630	25	10.0	16 x 76	338907	—	197,000	69	50,000 ^e
	355645	25	4.0	13 x 64	—	303313	197,000	69	50,000 ^e
Ultra-Clear	344085	50	13.5	16 x 76	341968	—	548,000	32	80,000
	344088	50	6.5	13 x 64	346256	303313	197,000	69	50,000
	344093	50	4.0	13 x 41	346256	303402	138,000	67	45,000
	344092	50	3.0	13 x 32	346256	303401	129,000	59	45,000
	344091	50	2.0	8 x 49	303624	303376	128,000	72	40,000

^a Set of two.

^b To simplify ordering, this g-Max™ Kit includes enough spacers to fill rotor, 50 tubes, and required tools.

Note: To help you locate g-Max tubes in the rotor listings, these tubes are highlighted with bold, italic type.

^c Bottle assembly.

^d Bottle only.

^e Maximum speeds given above are those which the tubes could withstand when tested at 25°C for 24 hours. Further tests have shown that the polycarbonate tubes can run at 75,000 rpm for six hours or at 65,000 rpm for eight hours.

Rotor Replacement Parts

- 839347 O-ring for Rotor Handle
- 356959 Tool, handle
- 355539 Overspeed Disk, 90,000 rpm
- 876089 O-ring for Rotor Lid

Adapters/Spacers/Caps



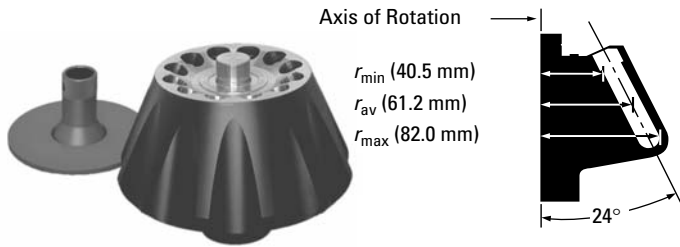

Fixed-Angle Rotor, Titanium

For use in instruments classified: **H R S**

Major applications: Differential centrifugation of subcellular particles.

Max. RPM	Max. g	k Factor	Number of Tubes	Rotor Capacity Volume/Size
70,000	450,000	36	12 x 13.5 mL 5/8 x 3 in 16 x 76 mm	162 mL

No. 342184. Type 70.1 Ti Rotor Assembly with 3 each 011757 O-rings, 3 each 858125 O-rings, 2 each 335585 Overspeed Disks.

No. 348179. Quick-Seal® Tube Kit with 2 boxes 342413 Polyallomer Tubes, 2 boxes 344322 Ultra-Clear™ Tubes, 12 each 342695 Spacers, and 306812 Spinkote™ Lubricant, and 335148 Vacuum Grease. (Cordless Tube Topper Kit and Tube Rack required; see Tools, Accessories, and Supplies.)

No. 348180. Open-Top Tube Kit with 2 boxes 326814 Polyallomer Tubes, 2 each 344085 Ultra-Clear Tubes, and 12 each 341968 Tube Caps, and 1 each 306812 Spinkote Lubricant, and 335148 Vacuum Grease. (331202 and 305075 Tools required; see Tools, Accessories, and Supplies.)

No. 361660. OptiSeal™ Tube Kit with 4 boxes of OptiSeal Tubes 361623, 12 Spacers 361670 (6 pkg of 2), 1 OptiSeal Tube Rack 361642, 1 Tube Extraction Tool 361668, and 1 Spacer Removal Tool 338765.

Tubes and Bottles

Tube Style/Material	Part No.	Quantity	Vol. (mL) g-Max	Size (mm)	Required Caps/ Spacers (qty. 1)	Required Adapters (qty. 1)	g-Force	k Factor	Max. Speed
OptiSeal Polyallomer	361623	56	8.9	16 x 60	361670*	—	450,000	32	70,000
Quick-Seal Polyallomer	342413	50	13.5	16 x 76	342695	—	450,000	36	70,000
	344622	50	10.0	16 x 67	344676	—	450,000	34	70,000
	345830	50	6.3	16 x 45	345828	—	450,000	24	70,000
	357334†	50	6.3	16 x 45	345828	—	450,000	24	70,000
	356562	50	4.2	16 x 38	345828	—	450,000	17	70,000
	357332‡	50	4.2	16 x 38	345828	—	450,000	17	70,000
Quick-Seal Ultra-Clear	344322	50	13.5	16 x 76	342695	—	450,000	36	70,000
Polycarbonate Bottle Assembly	355603	6	10.4	16 x 76	—	—	388,000	42	65,000
	Thinwall Polyallomer	326814 326820	50 50	13.5 6.5	16 x 76 13 x 64	341968 346256	— 303313	450,000 212,000	36 60
Thickwall Polyallomer	355640 355644	25 25	10.0 4.0	16 x 76 13 x 64	— —	— 303313	82,700 212,000	199 60	30,000‡ 50,000‡
	Thickwall Polycarbonate	355630 355645	25 25	8.0 4.0	16 x 76 13 x 64	— —	— 303313	230,000 212,000	71 60
Ultra-Clear	344085	50	13.5	16 x 76	341968	—	450,000	36	70,000
	344088	50	6.5	13 x 64	346256	303313	212,000	60	50,000
	344093	50	4.0	13 x 41	346256	303402	152,000	58	45,000
	344092	50	3.0	13 x 32	346256	303401	143,000	51	45,000
	344091	50	2.0	8 x 49	303624	303376	138,000	63	40,000

*Set of 2.

† To simplify ordering, this g-Max™ Kit includes enough spacers to fill rotor, 50 tubes, and required tools.

Note: To help you locate g-Max tubes in the rotor listings, these tubes are highlighted with bold, italic type.

‡ Maximum speeds given above are those which the tube could withstand when tested at 25°C for 24 hours. Further tests have shown that the polycarbonate tube can be run at 70,000 rpm for six hours or at 65,000 rpm for eight hours.

Rotor Replacement Parts

- 011757 O-ring for Rotor Handle
- 337924 Rotor Handle
- 335585 Overspeed Disk, 70,000 rpm
- 858125 O-ring for Rotor Lid
- 342183 Rotor Lid

Adapters/Spacers/Caps



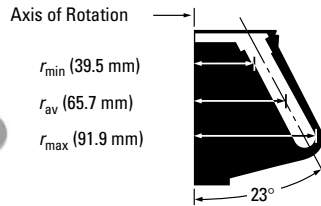

Fixed-Angle Rotor, Titanium

For use in instruments classified: **H R S**

Major applications: Differential centrifugation of subcellular fractions.

Max. RPM	Max. g	k Factor	Number of Tubes Volume/Size	Rotor Capacity
70,000	504,000	44	8 x 39 mL 1 x 3 1/2 in 25 x 89 mm	312 mL

No. 337922. Type 70 Ti Rotor Assembly with 3 each 011757 O-rings, 3 each 870612 O-rings, and 2 each 335585 Overspeed Disks.

No. 348178. Quick-Seal® Tube Kit with 2 boxes 342414 Polyallomer Tubes, 2 boxes 344326 Ultra-Clear™ Tubes, 12 each 342699 Spacers, 306812 Spinkote™ Lubricant, and 335148 Vacuum Grease. (Cordless Tube Topper Kit and Rack required; see Tools, Accessories, and Supplies.)

No. 348172. Open-Top Tube Kit with 4 boxes 344367 Polyallomer Tubes, 10 each 337927 Tube Caps, and 1 each 306812 Spinkote Lubricant, and 335148 Vacuum Grease. (338841 and 305075 Tools required; see Tools, Accessories, and Supplies.)

No. 361662. OptiSeal™ Tube Kit with 4 boxes of Tubes 361625, 12 Spacers 361669 (6 pkg of 2), 1 OptiSeal Tube Rack 361646, 1 Tube Extraction Tool 361668, and 1 Spacer Removal Tool 338765.

Tubes and Bottles

Tube Style/Material	Part No.	Quantity	Vol. (mL) g-Max	Size (mm)	Required Caps/ Spacers (qty. 1)	Required Adapters (qty. 1)	g-Force	k Factor	Max. Speed
OptiSeal Polyallomer	361625	56	32.4	25 x 77	361669 ^a	—	504,000	44	70,000
Quick-Seal Polyallomer	342414	50	39.0	25 x 89	342699	—	504,000	44	70,000
	344623	50	33.0	25 x 83	344635	—	504,000	38	70,000
	343665	50	27.0	25 x 64	343448	—	504,000	31	70,000
	357346 ^b	50	27.0	25 x 64	343448	—	504,000	31	70,000
	343664	50	15.0	25 x 38	343448	—	504,000	24	70,000
357343 ^b	50	15.0	25 x 38	343448	—	504,000	24	70,000	
Quick-Seal Ultra-Clear	344326	50	39.0	25 x 89	342699	—	504,000	44	70,000
	344323	50	27.0	25 x 64	343448	—	504,000	31	70,000
	344324	50	15.0	25 x 38	343448	—	504,000	24	70,000
Polycarbonate Bottle Assembly	355618	6	26.3	25 x 89	—	—	371,000	59	60,000
Thinwall Polyallomer	344367	50	35.5	25 x 83	337927	—	504,000	43	70,000
	326823	50	38.5	25 x 89	331151	—	371,000	59	60,000
	326814	50	13.5	16 x 76	330860	303307	151,000	104	40,000
	326820	50	6.5	13 x 64	346256	303392	102,000	69	45,000
Thickwall Polyallomer	355642	25	30.0	25 x 89	338906 ^c	—	371,000	59	60,000
	355640	25	10.0	16 x 76	338907 ^c	303307	151,000	104	40,000
	355644	25	4.0	13 x 64	—	303392	102,000	69	45,000
Thickwall Polycarbonate	355631	25	30.0	25 x 89	338906 ^c	—	371,000	59	60,000
	355630	25	10.0	16 x 76	338907 ^c	303307	151,000	104	40,000
	355645	25	4.0	13 x 64	—	303392	102,000	69	45,000
Ultra-Clear	344058	50	38.5	25 x 89	331151	—	371,000	59	60,000
	344085	50	13.5	16 x 76	330860	303307	151,000	104	40,000
	344088	50	6.0	13 x 64	346256	303392	102,000	69	45,000

^a Set of two.

^b To simplify ordering, this g-Max™ Kit includes enough spacers to fill rotor, 50 tubes, and required tools.

Note: To help you locate g-Max tubes in the rotor listings, these tubes are highlighted with bold, italic type.

^c Caps are optional for these Thickwall tubes. In the Type 70 Ti, the filling level for 355642 and 355631 is 16.5 mL. For 355640 and 355630, the filling level is 7.5 mL. Maximum speeds for these open-top tubes without a cap: Polycarbonate—45,000 rpm. Polyallomer—20,000 rpm. These speeds are those which the tubes could withstand when tested at 25°C for 24 hours. Further tests have shown that the polycarbonate tube can run at 50,000 rpm for four hours.

Rotor Replacement Parts

- 011757 O-ring for Rotor Handle
- 335585 Overspeed Disk, 70,000 rpm
- 337924 Rotor Handle
- 870612 O-ring for Rotor Lid
- 337923 Rotor Lid

Adapters/Spacers/Caps



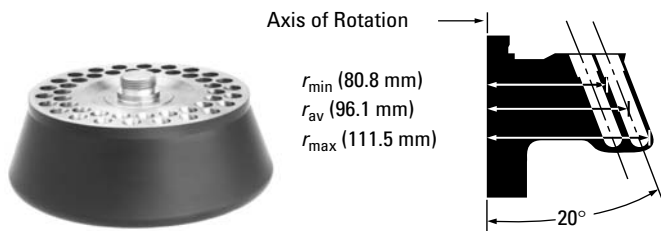

Fixed-Angle Rotor, Titanium

For use in instruments classified: **H R S**

Major applications: Differential flotation of lipoproteins, multisample pelleting, or gradient separations.

Max. RPM	Max. g	k Factor	Number of Tubes Volume/Size	Rotor Capacity
50,000	270,000 312,000	39 33	44 x 6.5 mL ½ x 2½ in 13 x 64 mm	286 mL

No. 347299. Type 50.4 Ti Rotor Assembly with 2 each 870138 O-rings, 2 each 854519 O-rings, and 1 extra 330336 Overspeed Disk.

No. 356957. Quick-Seal® Tube Kit with 2 boxes 344619 Polyallomer Tubes, 2 boxes 344320 Ultra-Clear™ Tubes, 48 each 344389 Spacers, 338765 QS Adapter Removal Tool, 306812 Spinkote™ Lubricant, and 335148 Vacuum Grease. (Cordless Tube Topper Kit required; see Tools, Accessories, and Supplies.)

No. 356956. Open-Top Tube Kit and Tube Rack for lipoprotein flotation with 4 boxes 326820 Polyallomer Tubes, 48 each 303113 Tube Caps with short stems, and 1 each 306812 Spinkote Lubricant, and 335148 Vacuum Grease. (301875, 305075, and 841883 Tools required.)

No. 356958. Open-Top Tube Kit with 2 boxes 326820 Polyallomer Tubes, 2 boxes 344088 Ultra-Clear Tubes, 48 each 346256 Tube Caps with fill holes, and 1 each 306812 Spinkote Lubricant, and 335148 Vacuum Grease. (301875, 305075, and 841883 Tools required.)

No. 361659. OptiSeal™ Tube Kit with 4 boxes of Tubes 361621, 8 Spacers 361676 (4 pkg of 2), 1 OptiSeal Tube Rack 361638, 1 Tube Extraction Tool 361668, and 1 Spacer Removal Tool 338765.

Tubes and Bottles

Tube Style/Material	Part No.	Quantity	Vol. (mL) g-Max	Size (mm)	Required Caps/ Spacers (qty. 1)	Required Adapters (qty. 1)	g-Force	k Factor	Max. Speed
OptiSeal Polyallomer	361621	56	4.7	13 x 48	361676*	—	312,000	33	50,000
Quick-Seal Polyallomer	344619	50	6.0	13 x 64	344389	—	312,000	33	50,000
	345829	50	2.0	13 x 25	345827	—	312,000	15	50,000
	357329†	50	2.0	13 x 25	345827	—	312,000	15	50,000
Quick-Seal Ultra-Clear	344320	50	6.0	13 x 64	344389	—	312,000	33	50,000
Thinwall Polyallomer	326820	50	6.5	13 x 64	346256	—	312,000	33	50,000
Thickwall Polyallomer	355644	25	4.0	13 x 64	—	—	112,400	91	30,000
Thickwall Polycarbonate	355645	25	4.0	13 x 64	—	—	312,000	33	50,000
	355657	25	1.0	8 x 51	—	303823	252,900	40	45,000
Thinwall Ultra-Clear	344088	50	6.5	13 x 64	346256	—	312,000	33	50,000
	344091	50	2.0	8 x 49	303658	303823	252,900	40	45,000

* Set of 2.

† To simplify ordering, this g-Max™ Kit includes enough spacers to fill rotor, 50 tubes, and required tools.

Note: To help you locate g-Max tubes in the rotor listings, these tubes are highlighted with bold, italic type.

Rotor Replacement Parts

- 330336 Overspeed Disk, 50,000 rpm
- 854519 O-ring for Rotor Handle
- 337904 Break-away Handle Assembly
- 870138 O-ring for Rotor Lid
- 347298 Rotor Lid

Adapters/Spacers/Caps



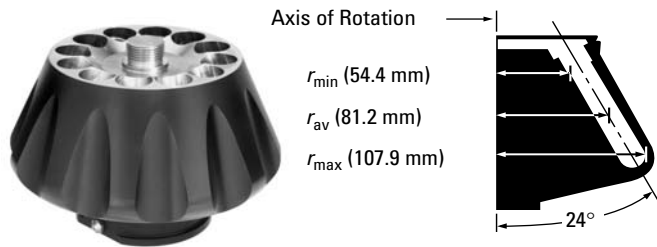

Fixed-Angle Rotor, Titanium

For use in instruments classified: **H R S**

Note: This rotor cannot be used in 40,000 rpm F or H instruments or the L5-50E unless the instruments have been upgraded with a diffusion pump and vacuum indicator.

Major applications: Differential centrifugation of subcellular fractions.

Max. RPM	Max. g	k Factor	Number of Tubes Volume/Size	Rotor Capacity
50,000	302,000	69	12 x 39 mL 1 x 3/4 in 25 x 89 mm	468 mL

No. 337901. Type 50.2 Ti Rotor Assembly with 3 each 834301 O-rings, 3 each 854519 O-rings, and 2 each 330336 Overspeed Disks.

No. 348178. Quick-Seal® Tube Kit with 2 boxes 342414 Polyallomer Tubes, 2 boxes 344326 Ultra-Clear™ Tubes, 12 each 342699 Spacers, 306812 Spinkote™ Lubricant, and 335148 Vacuum Grease. (Cordless Tube Topper Kit and Tube Rack required; see Tools, Accessories, and Supplies.)

No. 348177. Open-Top Tube Kit with 2 boxes 326823 Polyallomer Tubes, 2 boxes 344058 Ultra-Clear Tubes, and 12 each 331151 Tube Caps, and 1 each 306812 Spinkote Lubricant, and 335148 Vacuum Grease. (331202 and 305075 Tools required; see Tools, Accessories, and Supplies.)

No. 361662. OptiSeal™ Tube Kit with 4 boxes of Tubes 361625, 12 Spacers 361669 (6 pkg of 2), 1 OptiSeal Tube Rack 361646, 1 Tube Extraction Tool 361668, and 1 Spacer Removal Tool 338765.

Tubes and Bottles

Tube Style/Material	Part No.	Quantity	Vol. (mL) g-Max	Size (mm)	Required Caps/ Spacers (qty. 1)	Required Adapters (qty. 1)	g-Force	k Factor	Max. Speed
OptiSeal Polyallomer	361625	56	32.4	25 x 77	361669*	—	302,000	69	50,000
Quick-Seal Polyallomer	342414	50	39.0	25 x 89	342699	—	302,000	69	50,000
	344623	50	33.0	25 x 82	344635	—	302,000	68	50,000
	343665	50	27.0	25 x 64	343448	—	302,000	55	50,000
	357346**	50	27.0	25 x 64	343448	—	302,000	55	50,000
	343664	50	15.0	25 x 38	343448	—	302,000	39	50,000
	357343**	50	15.0	25 x 38	343448	—	302,000	39	50,000
Quick-Seal Ultra-Clear	344326	50	39.0	25 x 89	342699	—	302,000	69	50,000
	344323	50	27.0	25 x 64	343448	—	302,000	55	50,000
	344324	50	15.0	25 x 38	343448	—	302,000	39	50,000
Bottle Assembly Polycarbonate	355618	6	26.3	—	—	—	302,000	69	50,000
Thinwall Polyallomer	326823	50	38.5	25 x 89	331151	—	302,000	69	50,000
	326814	50	13.5	16 x 76	330860	303307	179,000	85	40,000
	326820	50	6.5	13 x 64	346256	303392	194,000	61	43,000
Thickwall Polyallomer	355642†	25	30.0	25 x 89	338906	—	302,000	69	50,000
	355640†	25	10.0	16 x 76	338907	303307	179,000	85	40,000
	355644	25	4.0	13 x 64	—	303392	194,000	61	43,000
Thickwall Polycarbonate	355631†	25	30.0	25 x 89	338906	—	302,000	69	50,000
	355630†	25	10.0	16 x 76	338907	303307	179,000	85	45,000
	355645	25	4.0	13 x 64	—	303392	194,000	61	43,000
Thinwall Ultra-Clear	344058	50	38.5	25 x 89	331151	—	302,000	69	50,000
	344085	50	13.5	16 x 76	330860	303307	179,000	85	40,000
	344088	50	6.5	13 x 64	346256	303392	194,000	61	43,000

** To simplify ordering, this g-Max™ Kit includes enough spacers to fill rotor, 50 tubes, and required tools.

Note: To help you locate g-Max tubes in the rotor listings, these tubes are highlighted with bold, italic type.

† Caps are optional for these thickwall tubes. In the Type 50.2 Ti, the filling level for 355642 and 355631 is 16.5 mL. For 355640 and 355630, the filling level is 8 mL. Maximum speeds for these open-top tubes without a cap: Polycarbonate — 45,000 rpm. Polyallomer — 20,000 rpm. These speeds are those which the tubes could withstand when tested at 25°C for 24 hours. Further tests have shown that the polycarbonate tube can be run at 50,000 rpm for four hours.

Rotor Replacement Parts

- 330336 Overspeed Disk, 50,000 rpm
- 834301 Large O-ring for Rotor Lid
- 854519 Small O-ring for Rotor Lid
- 337904 Rotor Handle Assembly
- 337903 Rotor Lid

Adapters/Spacers/Caps



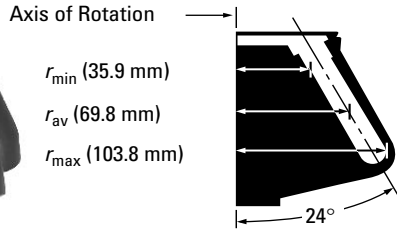

Fixed-Angle Rotor, Titanium

For use in instruments classified: **H R S**

Note: This rotor cannot be used in 40,000 rpm F or H instruments or the L5-50E unless the instruments have been upgraded with a diffusion pump and vacuum indicator.

Major applications: Differential centrifugation of large volumes of subcellular fractions and viruses.

Max. RPM	Max. g	k Factor	Number of Tubes Volume/Size	Rotor Capacity
45,000	235,000	133	6 x 94 mL 1½ x 4 in 38 x 102 mm	564 mL

No. 339160. Type 45 Ti Rotor Assembly with 3 each 854519 O-rings, 3 each 878260 O-rings, and 2 each 335458 Overspeed Disks.

No. 348175. Quick-Seal® Tube Kit with 4 boxes 345776 Polyallomer Tubes, 4 boxes 345778 Ultra-Clear™ Tubes, 8 each 342697 Spacers, 306812 Spinkote™ Lubricant, and 335148 Vacuum Grease. (Cordless Tube Topper Kit and Tube Rack required; see Tools, Accessories, and Supplies.)

No. 348176. Open-Top Tube Kit with 4 boxes 345775 Polyallomer Tubes, 4 boxes 345777 Ultra-Clear Tubes, and 8 each 330901 Tube Caps, and 1 each 306812 Spinkote Lubricant and 335148 Vacuum Grease. (331202 and 305075 Tools required; see Tools, Accessories, and Supplies.)

Tubes and Bottles

Tube Style/Material	Part No.	Quantity	Vol. (mL) g-Max	Size (mm)	Required Caps/ Spacers (qty. 1)	Required Adapters (qty. 1)	g-Force	k Factor	Max. Speed
Quick-Seal Polyallomer	345776	25	94.0	38 x 102	342697	—	235,000	133	45,000
Quick-Seal Ultra-Clear	345778	25	94.0	38 x 102	342697	—	235,000	133	45,000
Polycarbonate Bottle/Assembly	355622*	6	70.0	38 x 102	—	—	235,000	133	45,000†
	355651**	6	10.4	16 x 76	—	—	397,000	43	65,000
Thinwall Polyallomer	345775	25	94.0	38 x 102	330901	—	235,000	133	45,000
	326814	50	13.5	16 x 76	330860	303448	149,000	107	39,000
	326822	50	10.5	13 x 89	346256	303459	156,000	110	39,000
	326820	50	6.5	13 x 64	346256	303449	138,000	90	39,000
Thickwall Polyallomer	355643	25	81.0	38 x 102	338905†	—	235,000	133	45,000
	355640	25	10.0	16 x 76	338907†	303448	149,000	107	39,000
	355639	25	10.0	13 x 89	—	303459	156,000	110	39,000
	355641	25	3.5	11 x 80	—	350781	91,000	151	30,000
	355644	25	4.0	13 x 64	—	303449	138,000	90	39,000
Thickwall Polycarbonate	355628	25	81.0	38 x 102	338905†	—	235,000	133	45,000
	355630	25	10.0	16 x 76	338907†	303448	149,000	107	39,000
	355629	25	10.0	13 x 89	—	303459	156,000	110	39,000
	355632	25	3.5	11 x 80	—	350781	91,000	151	30,000
	355645	25	4.0	13 x 64	—	303449	138,000	90	39,000
Thinwall Ultra-Clear	345777	25	94.0	38 x 102	330901	—	235,000	133	45,000
	344085	50	13.5	16 x 76	330860	303448	149,000	107	39,000
	344087	50	10.5	13 x 89	346256	303459	156,000	110	39,000
	344088	50	6.5	13 x 64	346256	303449	138,000	90	39,000

* Bottle assembly. Reduce speed to 35,000 rpm when the bottle is centrifuged less than full (minimum fill volume is 35 mL).

** Bottle only. Reduce speed to 35,000 rpm when the bottle is centrifuged less than full (minimum fill volume is 35 mL).

† Caps are optional for these Thickwall tubes. In the Type 45 Ti the filling level for 355643 and 355628 is 47 mL. For 355640 and 355630, the filling level is 8 mL. Maximum speeds for these open-top tubes without a cap: Polycarbonate — 30,000 rpm; Polyallomer — 15,000 rpm.

Rotor Replacement Parts

- 335458 Overspeed Disk, 45,000 rpm
- 339164 Rotor Handle
- 854519 O-ring, small, for Rotor Lid
- 878260 O-ring, large, for Rotor Lid
- 339163 Rotor Lid

Adapters/Spacers/Caps

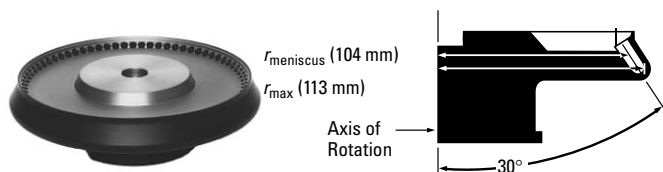

**Fixed-Angle Rotor, Titanium**For use in instruments classified: **H R S**

Major applications: Differential flotation of lipoproteins, rapid separation of viruses and microsomes.

Max. RPM	Max. g	k Factor	Number of Tubes	Rotor Capacity Volume/Size
42,000	223,000	9	72 × 230 μ L .29 × .8 in 7 × 20 mm	16.5 mL

1

No. 343007. Type 42.2 Rotor Package with one bag of 100 each 342303 Cellulose Propionate Tubes, 1 each 330329 Overspeed Disk, 332688 Vise Assembly, 343008 Spanner Wrench, 878446 Forceps, and 1 each 306812 Spinkote™ Lubricant, and 335148 Vacuum Grease.

Tubes

Tube Style/Material	Part No.	Quantity	Volume (μ L)	Size (mm)	Caps/ Spacers (qty. 1)	g-Force	k Factor	Maximum Speed
Cellulose Propionate	342303	100	230	7 × 20	—	223,000	9	42,000
Thickwall Polyallomer	343621	100	230	7 × 20	—	223,000	9	42,000
Thickwall Polycarbonate	343775	100	230	7 × 20	—	223,000	9	42,000

Note: Originally this rotor was intended for small-sample lipoprotein applications and was called the LP 42 Ti. However, it has become a popular choice for processing a variety of microsomes, and the name has been changed to the Type 42.2 Ti to reflect its more general use.

Rotor Replacement Parts

330329 Overspeed Disk, 42,000 rpm
885028 O-ring for Rotor Lid

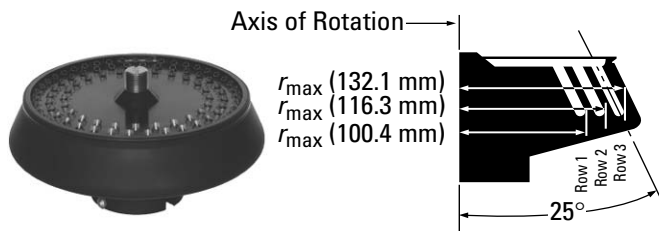

Fixed-Angle Rotor, Aluminum

For use in instruments classified: **H R S**

Major applications: Differential flotation of many small samples of lipoproteins.

Max. RPM	Max. g	k Factor	Number of Tubes Volume/Size	Rotor Capacity
25,000	70,300	84	100 x 1 mL	100 mL
	81,400	71	5/16 x 2 in	
	92,500	62	8 x 51 mm	

No. 347261. Type 25 Rotor Assembly with 3 each 011757 O-rings, 3 each 878272 O-rings, 2 each 330333 Overspeed Disks.

No. 348184. Quick-Seal® Tube Kit with 4 boxes 345831 Quick-Seal Polyallomer Tubes, 50 each 345824 Spacers, and 306812 Spinkote™ Lubricant, and 335148 Vacuum Grease. (Cordless Tube Topper Kit and Tube Rack required; see Tools, Accessories, and Supplies.)

No. 348635. Open-Top Tube Kit with 5 bags of 25 355657 Thickwall Polycarbonate Tubes, and 1 each 306812 Spinkote Lubricant, and 335148 Vacuum Grease.

Tubes

Tube Style/Material	Part No.	Quantity	Vol. (mL) g-Max	Size (mm)	Required Caps/ Spacers (qty. 1)	Required Adapters (qty. 1)	g-Force	k Factor	Max. Speed
Thickwall Polycarbonate	355657	25	1.0	8 x 51	—	—	92,500	62	25,000
Quick-Seal Polyallomer	345831	50	1.0	8 x 51	345824	—	92,500	62	25,000

Note: Dimensions and forces for the three rows of tubes in the Type 25 rotor are as follows:

	Row 1	Row 2	Row 3
r_{\min} (mm)	81.7	97.5	113.4
force (g)	57,200	68,300	79,400
r_{av} (mm)	91.1	106.9	122.8
force (g)	63,800	74,800	86,000
r_{\max} (mm)	100.4	116.3	132.1
force (g)	70,300	81,400	92,500

Rotor Replacement Parts

- 011757 O-ring for Rotor Handle
- 330333 Overspeed Disk, 25,000 rpm
- 335453 Overspeed Disk, 23,000 rpm
- 878272 O-ring for Rotor Body
- 347267 Rotor Handle
- 347266 Rotor Lid

Spacers

345824



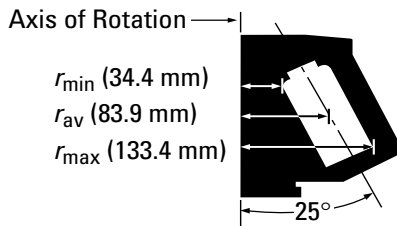

Fixed-Angle Rotor, Aluminum

For use in instruments classified: **H R S**

Major applications: Differential centrifugation of large volumes of viruses and large subcellular particles.

Max. RPM	Max. g	k Factor	Number of Tubes	Rotor Capacity Volume/Size
19,000	53,900	951	6 x 250 mL 2 5/8 x 4 3/4 in 60 x 120 mm	1500 mL

No. 325620. Type 19 Rotor Assembly with 3 each 325623 Gaskets, 3 each 801773 O-rings, and 2 extra 330331 Overspeed Disks.

No. 325632. Type 19 Rotor Package with 6 each 334205 250-mL Bottle and Cap Assemblies, 1 each 355627 (pkg of 6) 250-mL Bottle, 6 each 812715 O-rings, 2 spare 801773 O-rings, and 1 each 306812 Spinkote™ Lubricant, and 335148 Vacuum Grease.

Bottle

Tube Style/Material	Part No.	Quantity	Vol. (mL)	Size (mm)	g-Force	k Factor	Maximum Speed
Polyallomer	355627*	6	250.0	60 x 121	53,900	951	19,000
	334205**	1	250.0	60 x 121	53,900	951	19,000

* Bottle without Cap.

** Bottle with Cap Assembly.

Rotor Replacement Parts

- 325623 Gasket for Rotor Handle
- 325624 Rotor Handle
- 330331 Overspeed Disk, 19,000 rpm
- 801773 O-ring for Rotor Body
- 332826 Rotor Lid

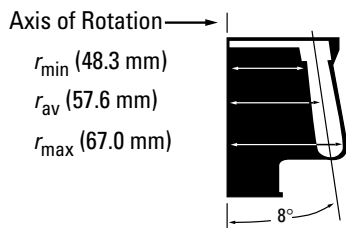

NVT™ Near-Vertical Tube Rotor, Titanium

For use in instruments classified: **R S**

Note: Non-precipitating solutions up to 1.7 g/mL in density can be run in this rotor without a reduction in rotor speed. For speed reductions for CsCl prescription, refer to rotor manual.

Major applications: Separation of plasmid or mitochondrial DNA in CsCl gradients in 2.5 - 4 h.

Max. RPM	Max. g	k Factor	Number of Tubes Volume/Size	Rotor Capacity
100,000	750,000	8	8 x 5.1 mL ½ x 2 in 13 x 51 mm	40.8 mL

Rotor Package: No. 365898. NVT 100 Rotor with 1 each 366011 Vise Adapter, 1 each 858121 Torque Wrench, 1 each 976959 Torx Plug-wrench Adapter, Supplies, including 306812 Spinkote™ Lubricant, and 1 Spare 363304 Overspeed Disk.

Quick-Seal® Tube Kit: No. 360979. Tube Kit with 4 boxes 342412 Polyallomer Quick-Seal Tubes, 8 each 342883 Spacers, 1 each 348122 Tube Topper Rack, 1 each 361668 Tube Removal Tool. (Tube Topper Kit required, see Tools, Accessories, and Supplies.)

Tube or Bottle

Tube Style/Material	Part No.	Quantity	Vol. (mL) g-Max	Size (mm)	Spacers (qty. 1)	Floating Spacers (qty. 1)	g-Force	k Factor	Max. Speed
Quick-Seal	342412	50	5.1	13 x 51	342883	—	750,000	8	100,000
Polyallomer	345829	50	2.0	13 x 25	342883	345827	750,000	6	100,000
	357325*	50	2.0	13 x 25	342883	345827	750,000	6	100,000

* To simplify ordering, this g-Max™ Kit includes enough spacers to fill rotor, 50 tubes, and required tools.

Note: To help you locate g-Max tubes in the rotor listings, these tubes are highlighted with bold, italic type.

Rotor Replacement Parts

For Rotors Manufactured Prior to 1/2000

- 363304 Overspeed Disk, 100,000 rpm
- 365892 Rotor Plug, Hex style†
- 342882 Gasket for Rotor Plug
- 365891 Hex Plug-wrench Adapter

For Rotors Manufactured After 1/2000

- 363304 Overspeed Disk, 100,000 rpm
- 368546 Rotor Replacement Plug (set of 8)
- 342882 Gasket for Rotor Plug
- 976959 Torx Adapter

† This rotor plug is no longer available. If replacing all rotor plugs, use Torx style, P/N 368546.

Adapters/Spacers

342883

345827



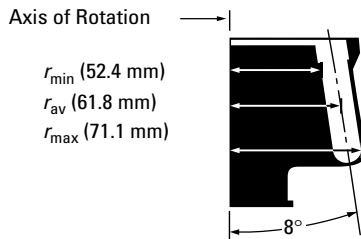

NVT™ Near-Vertical Tube Rotor, Titanium

For use in instruments classified: **H R S**

Note: Non-precipitating solutions up to 1.7 g/mL in density can be run in this rotor without a reduction in rotor speed. For speed reductions for CsCl prescription, refer to rotor manual.

Major applications: Separation of plasmid or mitochondrial DNA in CsCl gradients in 2.5 – 4 h.

Max. RPM	Max. g	k Factor	Number of Tubes	Rotor Capacity Volume/Size
90,000	645,000	10	8 x 5.1 mL ½ x 2 in 13 x 51 mm	40.8 mL

Rotor Package: No. 362752. NVT 90 Rotor with 1 each 342705 Vise, 1 each 858121 Torque Wrench, 1 each 976959 Torx Plug-wrench Adapter, and Supplies, including 306812 Spinkote™ Lubricant, and 1 spare 355539 Overspeed Disk.

OptiSeal™ Tube Kit: No. 360970. Tube Kit with 4 boxes 362185 Polyallomer OptiSeal Tubes, 8 each 362198 Spacers, 1 each 360534 Tube Rack, 1 each 361668 Tube Removal Tool, and 1 each 338765 Spacer Removal Tool.

Quick-Seal® Tube Kit: No. 360979. Tube Kit with 4 boxes 342412 Polyallomer Quick-Seal Tubes, 8 each 342883 Spacers, 1 each 348122 Tube Topper Rack, 1 each 361668 Tube Removal Tool. (Cordless Tube Topper Kit required, see Tools, Accessories, and Supplies.)

Tubes

Tube Style/Material	Part No.	Quantity	Vol. (mL) g-Max	Size (mm)	Spacers (qty. 1)	Floating Spacers (qty. 1)	g-Force	k Factor	Max. Speed
OptiSeal Polyallomer	362185	56	4.9	13 x 51	362198	—	645,000	10	90,000
Quick-Seal Polyallomer	342412	50	5.1	13 x 51	342883	—	645,000	10	90,000
	345829	50	2.0	13 x 25	342883	345827	645,000	7	90,000
	357325*	50	2.0	13 x 25	342883	345827	645,000	7	90,000
Quick-Seal Ultra-Clear™	344075	50	5.1	13 x 51	342883	—	645,000	10	90,000

* To simplify ordering, this g-Max™ Kit includes enough spacers to fill rotor, 50 tubes, and required tools.

Note: To help you locate g-Max tubes in the rotor listings, these tubes are highlighted with bold, italic type.

Rotor Replacement Parts

For Rotors Manufactured Prior to 1/2000

- 355539 Overspeed Disk, 90,000 rpm
- 342881 Rotor Plug, Hex style†
- 342882 Gasket for Rotor Plug

For Rotors Manufactured After 1/2000

- 355539 Overspeed Disk, 90,000 rpm
- 368545 Rotor Replacement Plug (set of 8)
- 342882 Gasket for Rotor Plug
- 976959 Torx Adapter

† This part number is no longer available. If replacing all rotor plugs, use Torx style, PIN 368545.

Adapters/Spacers



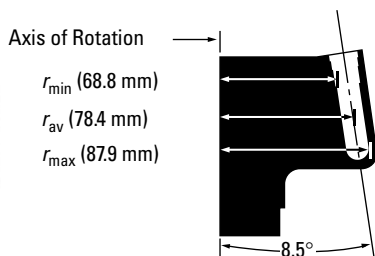

NVT™ Near-Vertical Tube Rotor, Titanium

For use in instruments classified: **H R S**

Note: Solutions up to 1.7 g/mL in density can be run in this rotor without a reduction in rotor speed.

Major applications: Separation of plasmid, mitochondrial, or chromosomal DNA, proteoglycans, and lipoproteins.

Max. RPM	Max. g	k Factor	Number of Tubes	Rotor Capacity Volume/Size
65,000	416,000	15	16 x 5.1 mL ½ x 2 in 13 x 51 mm	81.6 mL

Rotor Package: No. 361073. NVT 65.2 Rotor with 1 each 342705 Vise, 1 each 858121 Torque Wrench, 1 each 976959 Torx Plug-wrench Adapter, and Supplies, including 306812 Spinkote™ Lubricant, and 1 each 330338 Overspeed Disk.

OptiSeal™ Tube Kit: No. 360972. Tube Kit with 4 each 362185 Polyallomer OptiSeal Tubes, 16 each 362198 Spacers, 2 each 360534 Tube Racks, 1 each 361668 Tube Removal Tool, and 1 each 338765 Spacer Removal Tool.

Quick-Seal® Tube Kit: No. 360977. Tube Kit with 4 each 342412 Polyallomer Quick-Seal Tubes, 16 each 342883 Spacers, 1 each 348122 Tube Topper Tube Rack, and 1 each 361668 Tube Removal Tool. (Cordless Tube Topper Kit required, see Tools, Accessories, and Supplies.)

Tubes

Tube Style/Material	Part No.	Quantity	Vol. (mL) g-Max	Size (mm)	Spacers (qty. 1)	Floating Spacers (qty. 1)	g-Force	k Factor	Max. Speed
OptiSeal Polyallomer	362185	56	4.9	13 x 51	362198	—	416,000	15	65,000
Quick-Seal Polyallomer	342412	50	5.1	13 x 51	342883	—	416,000	15	65,000
	345829	50	2.0	13 x 25	342883	345827	416,000	7	65,000
	357326*	50	2.0	13 x 25	342883	345827	416,000	7	65,000
Quick-Seal Ultra-Clear™	344075	50	5.1	13 x 51	342883	—	416,000	15	65,000

* To simplify ordering, this g-Max Kit™ includes enough spacers to fill rotor, 50 tubes, and required tools.

Note: To help you locate g-Max tubes in the rotor listings, these tubes are highlighted with bold, italic type.

Rotor Replacement Parts

For Rotors Manufactured Prior to 1/2000

- 330338 Overspeed Disk, 65,000 rpm
- 342881 Rotor Plug, Hex style†
- 342882 Gasket for Rotor Plug

For Rotors Manufactured After 1/2000

- 330338 Overspeed Disk, 65,000 rpm
- 368545 Rotor Replacement Plug (set of 8)
- 342882 Gasket for Rotor Plug
- 976959 Torx Adapter

† This part number is no longer available. If replacing all rotor plugs, use Torx style, PIN 368545.

Adapters/Spacers



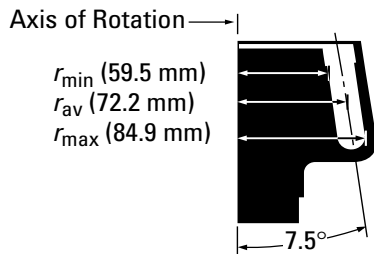

NVT™ Near-Vertical Tube Rotor, Titanium

For use in instruments classified: **H R S**

Note: Non-precipitating solutions up to 1.7 g/mL in density can be run in this rotor without a reduction in rotor speed.

Major applications: Separation of plasmid or mitochondrial DNA in CsCl gradients.

Max. RPM	Max. g	k Factor	Number of Tubes Volume/Size	Rotor Capacity
65,000	402,000	21	8 x 13.5 mL 5/8 x 3 in 16 x 76 mm	108 mL

Rotor Package No. 362755. NVT 65 Near-Vertical Tube Rotor Assembly with 12 each 349290 Washers, 2 each 330338 Overspeed Disks, 1 each 342705 Vise, 1 each 858121 Torque Wrench, 1 each 976959 Torx Wrench Adapter.

OptiSeal™ Tube Kit: No. 360973. Tube Kit with 4 boxes 362181 Polyallomer OptiSeal Tubes, 8 each 362202 Spacers, 1 each 360538 Tube Rack, 1 each 361668 Tube Removal Tool, and 1 each 338765 Spacer Removal Tool.

Quick-Seal® Tube Kit: No. 360976. Tube Kit with 4 boxes 342413 Polyallomer Quick-Seal Tubes, 8 each 349289 Spacers, 1 each 348123 Tube Topper Tube Rack, 1 each 361668 Tube Removal Tool. (Cordless Tube Topper Kit required, see Tools, Accessories, and Supplies.)

Tubes

Tube Style/Material	Part No.	Quantity	Vol. (mL) g-Max	Size (mm)	Spacers (qty. 1)	Floating Spacers (qty. 1)	g-Force	k Factor	Max. Speed
OptiSeal Polyallomer	362181	56	11.2	16 x 70	362202	—	402,000	17	65,000
Quick-Seal Polyallomer	342413	50	13.5	16 x 76	349289	—	402,000	21	65,000
	344622	50	10.0	16 x 67	349289	349901	402,000	15	65,000
	344621	50	8.0	16 x 58	349289	356571	402,000	11	65,000
	357337*	50	8.0	16 x 58	349289	356571	402,000	11	65,000
	345830	50	6.3	16 x 44	349289	349900	402,000	8	65,000
	357335*	50	6.3	16 x 44	349289	349900	402,000	8	65,000
Quick-Seal Ultra-Clear™	344322	50	13.5	16 x 76	349289	—	402,000	21	65,000

* To simplify ordering, this g-Max™ Kit includes enough spacers to fill rotor, 50 tubes, and required tools.

Note: To help you locate g-Max tubes in the rotor listings, these tubes are highlighted with bold, italic type.

Rotor Replacement Parts

For Rotors Manufactured Prior to 7/02

- 330338 Overspeed Disk, 65,000 rpm
- 355875 Rotor Plug, Hex Style†
- 349290 Gasket for Rotor Plug
- 356306 Wrench Adapter for Hex Plug

For Rotors Manufactured After 7/02

- 330338 Overspeed Disk, 65,000 rpm
- 392084 Rotor Plug (set of 8)
- 349290 Gasket for Rotor Plug
- 976959 Torx Wrench Adapter

† If replacing all rotor plugs, use Torx Style, P/N 392084.

Adapters/Spacers

349900 349901 349289 356571 362202



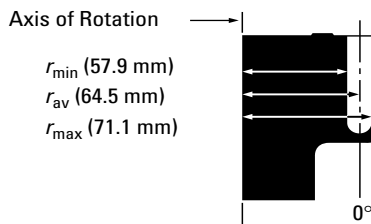

Vertical-Tube Rotor, Titanium

For use in instruments classified: **H R S**

Note: Solutions up to 1.7 g/mL in density can be run in this rotor without reduction in rotor speed.

Major applications: High-speed density gradient separations.

Max. RPM	Max. g	k Factor	Number of Tubes Volume/Size	Rotor Capacity
90,000	645,000	6	8 x 5.1 mL ½ x 2 in 13 x 51 mm	40.8 mL

Rotor Package: No. 362751. VTi 90 Rotor with 1 each 342705 Vise, 1 each 858121 Torque Wrench, 1 each 976959 Torx Plug-wrench Adapter, and Supplies, including 306812 Spinkote™ Lubricant, and 1 each 355539 Overspeed Disk.

OptiSeal™ Tube Kit: No. 360970. Tube Kit with 4 boxes 362185 Polyallomer OptiSeal Tubes, 8 each 362198 Spacers, 1 each 360534 Tube Rack, 1 each 361668 Tube Removal Tool, and 1 each 338765 Spacer Removal Tool.

Quick-Seal® Tube Kit: No. 360979. Tube Kit with 4 boxes 342412 Polyallomer Quick-Seal Tubes, 8 each 342883 Spacers, 1 each 348122 Tube Topper Tube Rack, and 1 each 361668 Tube Removal Tool. (Cordless Tube Topper Kit required, see Tools, Accessories, and Supplies.)

Tubes

Tube Style/Material	Part No.	Quantity	Vol. (mL) g-Max	Size (mm)	Spacers (qty. 1)	Floating Spacers (qty. 1)	g-Force	k Factor	Max. Speed
OptiSeal Polyallomer	362185	56	4.9	13 x 51	362198	—	645,000	6	90,000
Quick-Seal Polyallomer	342412	50	5.1	13 x 51	342883	—	645,000	6	90,000
	345829	50	2.0	13 x 25	342883	345827	645,000	6	90,000
	349621	50	3.5	13 x 32	342883	356866	645,000	6	90,000
	357325*	50	2.0	13 x 25	342883	345827	645,000	6	90,000
Quick-Seal Ultra-Clear™	344075	50	5.1	13 x 51	342883	—	645,000	6	90,000

* To simplify ordering, this g-Max™ Kit includes enough spacers to fill rotor, 50 tubes, and required tools.

Note: To help you locate g-Max tubes in the rotor listings, these tubes are highlighted with bold, italic type.

Rotor Replacement Parts

For Rotors Manufactured Prior to 1/2000

355539 Overspeed Disk, 90,000 rpm
342881 Rotor Plug, Hex style†
342882 Gasket for Rotor Plug

For Rotors Manufactured After 1/2000

355539 Overspeed Disk, 90,000 rpm
368545 Rotor Replacement Plug (set of 8)
342882 Gasket for Rotor Plug
976959 Torx Adapter

† This part number is no longer available. If replacing all rotor plugs, use Torx style, PIN 368545.

Adapters/Spacers

342883 345827 356866 362198



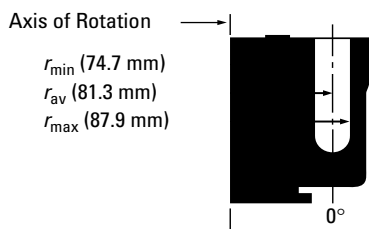

Vertical-Tube Rotor, Titanium

For use in instruments classified: **H R S**

Note: Solutions up to 1.7 g/mL in density can be run in this rotor without reduction in rotor speed.

Major applications: Isopycnic and rate-zonal centrifugation of small particles.

Max. RPM	Max. g	k Factor	Number of Tubes Volume/Size	Rotor Capacity
65,000	416,000	10	16 x 5.1 mL ½ x 2 in 13 x 51 mm	81.6 mL

Rotor Package: No. 362754. VTi 65.2 Rotor with 1 each 342705 Vise, 1 each 858121 Torque Wrench, 1 each 976959 Torx Plug-wrench Adapter, and Supplies, including 306812 Spinkote™ Lubricant, and 1 each 330338 Overspeed Disk.

OptiSeal™ Tube Kit: No. 360972. Tube kit with 4 boxes 362185 Polyallomer OptiSeal Tubes, 16 each 362198 spacers, 2 each 360534 Tube Racks, 1 each 361668 Tube Removal Tool, and 1 each 338765 Spacer Removal Tool.

Quick-Seal® Tube Kit: No. 360977. Tube Kit with 4 boxes 342412 Polyallomer Quick-Seal Tubes, 16 each 342883 Spacers, 1 each 348122 Tube Topper Tube Rack, and 1 each 361668 Tube Removal Tool. (Cordless Tube Topper Kit required, see Tools, Accessories, and Supplies.)

Tubes

Tube Style/Material	Part No.	Quantity	Vol. (mL) g-Max	Size (mm)	Spacers (qty. 1)	Floating Spacers (qty. 1)	g-Force	k Factor	Max. Speed
OptiSeal Polyallomer	362185	56	4.9	13 x 51	362198	—	416,000	10	65,000
Quick-Seal Polyallomer	342412	50	5.1	13 x 51	342883	—	416,000	10	65,000
	345829	50	2.0	13 x 25	342883	345827	416,000	10	65,000
	357326*	50	2.0	13 x 25	342883	345827	416,000	10	65,000
Quick-Seal Ultra-Clear™	344075	50	5.1	13 x 51	342883	—	416,000	10	65,000

* To simplify ordering, this g-Max™ Kit includes enough spacers to fill rotor, 50 tubes, and required tools.

Note: To help you locate g-Max tubes in the rotor listings, these tubes are highlighted with bold, italic type.

Rotor Replacement Parts

For Rotors Manufactured Prior to 1/2000

330338 Overspeed Disk, 65,000 rpm
342881 Rotor Plug, Hex style†
342882 Gasket for Rotor Plug

For Rotors Manufactured After 1/2000

330338 Overspeed Disk, 65,000 rpm
368545 Rotor Replacement Plug (set of 8)
342882 Gasket for Rotor Plug
976959 Torx Adapter

† This part number is no longer available. If replacing all rotor plugs, use Torx style, P/N 368545.

Adapters/Spacers

342883

345827

362198



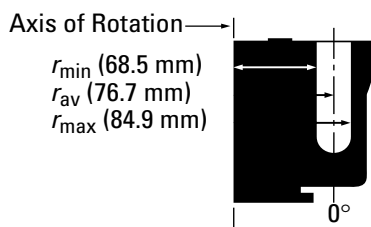

Vertical-Tube Rotor, Titanium

For use in instruments classified: **H R S**

Note: Solutions up to 1.7 g/mL in density can be run in this rotor without reduction in rotor speed.

Major applications: Isopycnic and rate-zonal centrifugation of small particles.

Max. RPM	Max. g	k Factor	Number of Tubes Volume/Size	Rotor Capacity
65,000	402,000	13	8 x 13.5 mL 5/8 x 3 in 16 x 76 mm	108 mL

Rotor Package: No. 362759. VTi 65.1 Rotor Assembly with 12 each 349290 Washers, 2 each 330338 Overspeed Disks, 1 each 342705 Vise, 1 each 306812 Spinkote™ Lubricant, 1 each 858121 Torque Wrench, 1 each 976959 Torx Wrench Adapter.

OptiSeal™ Tube Kit: No. 360973. Tube Kit with 4 boxes 362181 Polyallomer OptiSeal Tubes, 8 each 362202 Spacers, 1 each 360538 Tube Rack, 1 each 361668 Tube Removal Tool, and 1 each 338765 Spacer Removal Tool.

Quick-Seal® Tube Kit: No. 360976. Tube Kit with 4 boxes 342413 Polyallomer Quick-Seal Tubes, 8 each 349289 Spacers, 1 each 348123 Tube Topper Tube Rack, and 1 each 361668 Tube Removal Tool. (Cordless Tube Topper Kit required, see Tools, Accessories, and Supplies.)

Tubes

Tube Style/Material	Part No.	Quantity	Vol. (mL) g-Max	Size (mm)	Spacers (qty. 1)	Floating Spacers (qty. 1)	g-Force	k Factor	Max. Speed
OptiSeal Polyallomer	362181	56	11.2	16 x 67	362202	—	402,000	13	65,000
Quick-Seal Polyallomer	342413	50	13.5	16 x 76	349289	—	402,000	13	65,000
	344622	50	10.0	16 x 67	349289	349901	402,000	13	65,000
	344621	50	8.0	16 x 58	349289	356571	402,000	13	65,000
	357337*	50	8.0	16 x 58	349289	356571	402,000	13	65,000
	345830	50	6.3	16 x 45	349289	349900	402,000	13	65,000
	357335*	50	6.3	16 x 45	349289	349900	402,000	13	65,000
Quick-Seal Ultra-Clear™	344322	50	13.5	16 x 76	349289	—	402,000	13	65,000

* To simplify ordering, this g-Max™ Kit includes enough spacers to fill rotor, 50 tubes, and required tools.

Note: To help you locate g-Max tubes in the rotor listings, these tubes are highlighted with bold, italic type.

Rotor Replacement Parts

For Rotors Manufactured Prior to 8/87

330338 Overspeed Disk, 65,000 rpm
 349288 Rotor Plug, Square-hole Style†
 349290 Plug Gasket

For Rotors Manufactured from 8/87 to 7/02

330338 Overspeed Disk, 65,000 rpm
 355875 Rotor Plug, Hex-style†
 349290 Gasket for Plug
 356306 Wrench Adapter, Hex-style

For Rotors Manufactured After 7/02

330338 Overspeed Disk, 65,000 rpm
 392084 Rotor Plug, Torx (set of 8)
 349290 Gasket for Rotor Plug
 976959 Wrench Adapter for Torx Plug

† If replacing all rotor plugs, use Torx Style, P/N 392084.

Adapters/Spacers

349900 349901 349289 356571 362202



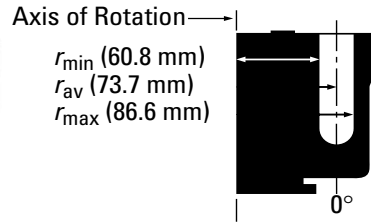

Vertical-Tube Rotor, Titanium

For use in instruments classified: **H R S**

Note: Solutions up to 1.7 g/mL in density can be run in this rotor without reduction in rotor speed.

Major applications: Isopycnic and rate-zonal centrifugation.

Max. RPM	Max. g	k Factor	Number of Tubes Volume/Size	Rotor Capacity
50,000	242,000	36	8 x 39 mL 1 x 3½ in 25 x 89 mm	312 mL

Rotor Package: No. 362758. VTi 50 Rotor with 1 each 332688 Vise, 1 each 889096 Torque Wrench, 1 each 355588 Hex Plug-wrench Adapter, and 2 spare 330336 Overspeed Disks.

OptiSeal™ Tube Kit: No. 360974. Tube kit with 4 boxes 362183 Polyallomer OptiSeal Tubes, 10 each 362204 Spacers, 1 each 360542 Tube Rack, and 1 each 361668 Tube Removal Tool.

Quick-Seal® Tube Kit: No. 360975. Tube Kit with 4 boxes 342414 Polyallomer Quick-Seal Tubes, 10 each 342417 Spacers, 1 each 348124 Tube Topper Tube Rack, and 1 each 361668 Tube Removal Tool. (Cordless Tube Topper Kit required, see Tools, Accessories, and Supplies.)

Tubes

Tube Style/Material	Part No.	Quantity	Vol. (mL) g-Max	Size (mm)	Spacers (qty. 1)	Floating Spacers (qty. 1)	g-Force	k Factor	Max. Speed
OptiSeal Polyallomer	362183	56	36.2	25 x 86	362204	—	242,000	36	50,000
Quick-Seal Polyallomer	342414	50	39.0	25 x 89	342417	—	242,000	36	50,000
	343665	50	27.0	25 x 64	342417	343448	242,000	36	50,000
	343664	50	15.0	25 x 38	342417	343448†	242,000	36	50,000
	357344*	50	15.0	25 x 38	342417	343448	242,000	36	50,000
Quick-Seal Ultra-Clear™	344326	50	39.0	25 x 89	342417	—	242,000	36	50,000
	344323	50	27.0	25 x 64	342417	343448	242,000	36	50,000
	344324	50	15.0	25 x 38	342417	343448†	242,000	36	50,000

* To simplify ordering, this g-Max™ Kit includes enough spacers to fill rotor; 50 tubes, and required tools.

Note: To help you locate g-Max tubes in the rotor listings, these tubes are highlighted with bold, italic type.

† Two required.

Rotor Replacement Parts

For Rotors Manufactured Prior to 8/87

330336 Overspeed Disk, 50,000 rpm
340603 Rotor Plug, Four-hole style
340825 Gasket for Rotor Plug
340632 Four-hole Plug-wrench Adapter-2 Prongs

For Rotors Manufactured After 8/87

330336 Overspeed Disk, 50,000 rpm
355587 Rotor Plug, Hex Style*
340825 Gasket for Rotor Plug
355588 Hex Plug-wrench Adapter

*If replacing all Rotor Plugs, use Hex Style.

Adapters/Spacers



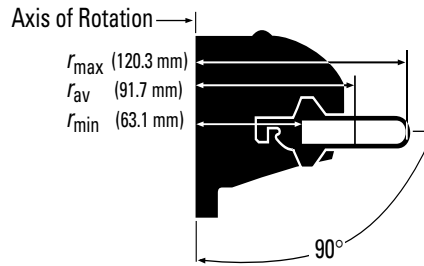

Swinging-Bucket Rotor, Titanium Head, and Buckets

For use in instruments classified: **H R S**

Major applications: Rate-zonal centrifugation of proteins and RNA, differential centrifugation of subcellular fractions.

Max. RPM	Max. g	k Factor	Number of Tubes Volume/Size	Rotor Capacity
60,000	485,000	45	6 x 4 mL 7/16 x 2 3/8 in 11 x 60 mm	24 mL

Rotor Package: No. 335650. SW 60 Ti Rotor with 001878 Cap Tool, 2 boxes 328874 Polyallomer Tubes, 2 boxes 344062 Ultra-Clear™ Tubes, 331313 Bucket Holder Rack, and Spare Parts/Supplies — 335148 Vacuum Grease, 306812 Spinkote™ Lubricant, 331155 Overspeed Disk, and 868638 Set of 4 O-rings for Buckets.

Rotor Assembly: No. 335649. SW 60 Ti Rotor and Bucket Set.

Tubes

Tube Style/Material	Part No.	Quantity	Vol. (mL) g-Max	Size (mm)	Floating Spacers (qty. 1)	Adapters (qty. 1)	g-Force	k Factor	Max. Speed
Quick-Seal® Polyallomer	344624	50	1.5	11 x 25	344674	—	485,000	24	60,000
	357323*	50	1.5	11 x 25	344674	—	485,000	24	60,000
	344625	50	2.0	11 x 32	344674	—	485,000	29	60,000
	357324*	50	2.0	11 x 32	344674	—	485,000	29	60,000
Quick-Seal konical™ Polyallomer	358655	50	1.3	11 x 35	344674	358152	480,000	31	60,000
	358648	50	3.0	11 x 60	344674	358152	480,000	45	60,000
Polyallomer	328874	50	4.0	11 x 60	—	—	485,000	45	60,000
konical Polyallomer	358117	50	1.5	11 x 35	—	358152	480,000	31	60,000
	358118	50	3.0	11 x 60	—	358152	480,000	45	60,000
Thickwall Polyallomer	355636	25	3.0	11 x 60	—	—	485,000	45	60,000
Thickwall Polycarbonate	355635	25	3.0	11 x 60	—	—	485,000	45	60,000
Ultra-Clear	344062	50	4.0	11 x 60	—	—	485,000	45	60,000

* To simplify ordering, this g-Max™ Kit includes enough spacers to fill rotor, 50 tubes, and required tools.

Note: To help you locate g-Max tubes in the rotor listings, these tubes are highlighted with bold, italic type.

Rotor Replacement Parts

- 331155 Overspeed Disk, 60,000 rpm
- 335459 Overspeed Disk, 54,000 rpm
- 331313 Bucket Holder Rack
- 332400 Rotor Stand
- 868638 O-ring for Bucket, set of 4
- 335645 Bucket Cap (each)
- 337943 Bucket Assembly, Titanium, with Caps and O-rings, matched set of 6

Adapters/Spacers

344674 358152



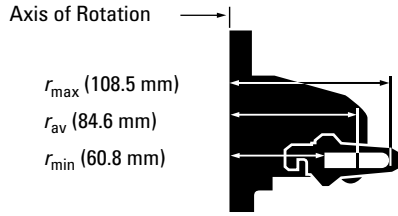

Swinging-Bucket Rotor, Titanium Head, and Buckets (red buckets)

For use in instruments classified: **H R S**

Major applications: Rate-zonal separations of small particles.

Max. RPM	Max. g	k Factor	Number of Tubes Volume/Size	Rotor Capacity
55,000	368,000	48	6 x 5 mL ½ x 2 in 13 x 51 mm	30 mL

1

Rotor Package: No. 342196. SW 55 Ti Rotor with 330070 Cap Tool, 2 boxes 326819 Polyallomer Tubes, 2 boxes 344057 Ultra-Clear™ Tubes, 331313 Bucket Holder Rack, and Spare Parts/Supplies — 306812 Spinkote™ Lubricant, 335148 Vacuum Grease, extra 328896 Overspeed Disk, and 824412 O-rings.

OptiSeal™ Tube Kit: No. 361661. Includes 4 boxes of Tubes 361627, 6 Spacers 361678 (3 pkg of 2), 1 OptiSeal Tube Rack 361650, 1 Tube Extraction Tool 361668.

Rotor Assembly: No. 342194. SW 55 Ti Rotor and Bucket Set.

Tubes

Tube Style/Material	Part No.	Quantity	Vol. (mL) g-Max	Size (mm)	Floating Spacers (qty. 1)	Adapters (qty. 1)	g-Force	k Factor	Max. Speed
OptiSeal Polyallomer	361627	56	3.3	13 x 33	361678*	—	368,000	48	55,000
Quick-Seal® Polyallomer	345829	50	2.0	13 x 25	355535	—	368,000	29	55,000
	357327†	50	2.0	13 x 25	355535	—	368,000	29	55,000
Quick-Seal konical™ Polyallomer	358647	50	3.2	13 x 51	355535	358153	368,000	48	55,000
Polyallomer	326819	50	5.0	13 x 51	—	—	368,000	48	55,000
konical Polyallomer	358119	50	3.0	13 x 51	—	358153	368,000	48	55,000
Thickwall Polyallomer	349623	25	3.5	13 x 51	—	—	368,000	48	55,000
Thickwall Polycarbonate	349622	25	3.5	13 x 51	—	—	368,000	48	55,000
Ultra-Clear	344057	50	5.0	13 x 51	—	—	368,000	48	55,000
	344090	50	0.8	5 x 41	—	356860‡	269,000	64	48,000

* Set of 2.
 †To simplify ordering, this g-Max™ Kit includes enough spacers to fill rotor; 50 tubes, and required tools.
 ‡ Adapter 305527 can be used for speeds up to 25,000 rpm.
 Note: To help you locate g-Max tubes in the rotor listings, these tubes are highlighted with bold, italic type.

Rotor Replacement Parts

- 330336 Overspeed Disk, 50,000 rpm
- 328896 Overspeed Disk, 55,000
- 331313 Bucket Holder Rack
- 332400 Rotor Stand
- 342199 Bucket Assembly, Titanium, with Caps and O-rings, matched set of 6
- 824412 O-ring for Bucket
- 342190 Bucket Cap (each)

Adapters/Spacers



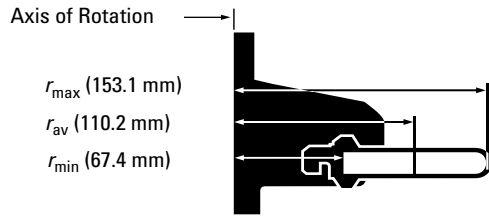

Swinging-Bucket Rotor, Titanium Head, and Buckets (black buckets)

For use in instruments classified: **H R S**

Major applications: Rate-zonal and isopycnic centrifugation of viruses, rate-zonal centrifugation of RNA.

Max. RPM	Max. g	k Factor	Number of Tubes Volume/Size	Rotor Capacity
41,000	288,000	124	6 x 13.2 mL 1/16 x 3 1/2 in 14 x 89 mm	79.2 mL

Rotor Package: No. 331336. SW 41 Ti Rotor with 330070 Hinge Pin Tool, 331313 Bucket Holder Rack, 2 boxes 331372 Polyallomer Tubes, 2 boxes 344059 Ultra-Clear™ Tubes, and Spare Parts/Supplies — 335148 Vacuum Grease, 306812 Spinkote™ Lubricant, 330335 Overspeed Disk, and 331309 Gaskets for Buckets.

Rotor Assembly: No. 331362. SW 41 Ti Rotor and Bucket Set.

Tubes

Tube Style/Material	Part No.	Quantity	Vol. (mL) g-Max	Size (mm)	Floating Spacers (qty. 1)	Adapters (qty. 1)	g-Force	k Factor	Max. Speed
Quick-Seal® Polyallomer	355537	50	5.9	14 x 47	355534	—	288,000	55	41,000
	355870	50	3.5	14 x 25	355534	—	288,000	27	41,000
	357330*	50	3.5	14 x 25	355534	—	288,000	27	41,000
Quick-Seal konical™ Polyallomer	358649	50	8.0	14 x 89	355534	358154	284,000	124	41,000
	358650	50	4.0	14 x 48	355534	358154	284,000	57	41,000
Polyallomer	331372	50	13.2	14 x 89	—	—	288,000	124	41,000
konical Polyallomer	358120	50	10.0	14 x 89	—†	358154	284,000	124	41,000
Ultra-Clear	344059	50	13.2	14 x 89	—	—	288,000	124	41,000

* To simplify ordering, this g-Max™ Kit includes enough spacers to fill rotor, 50 tubes, and required tools.

† Recommend 354468 Extractor Tool (konical tube adapters).

Note: To help you locate g-Max tubes in the rotor listings, these tubes are highlighted with bold, italic type.

Rotor Replacement Parts

- 330335 Overspeed Disk, 41,000 rpm
- 333761 Overspeed Disk, 36,000 rpm
- 331313 Bucket Holder Rack
- 332400 Rotor Stand
- 333790 Bucket Assembly, Black Titanium, with Caps and Gaskets, matched set of 6
- 331309 Gasket for Bucket
- 331763 Caps, matched set of 6

Adapters/Spacers

355534

358154



1

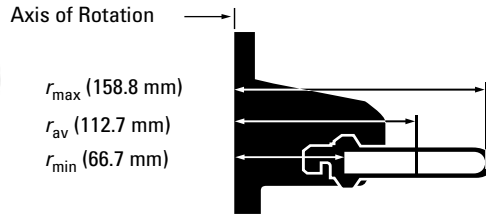

Swinging-Bucket Rotor, Titanium Head, and Buckets (red buckets)

For use in instruments classified: **H R S**

Major applications: Rate-zonal centrifugation of proteins, RNA and subcellular particles.

Max. RPM	Max. g	k Factor	Number of Tubes Volume/Size	Rotor Capacity
40,000	285,000	137	6 x 14 mL 1/16 x 3/4 in 14 x 95 mm	84 mL

Rotor Package: No. 331301. SW 40 Ti Rotor with 330070 Hinge Pin Tool, 2 boxes 331374 Polyallomer Tubes, 2 boxes 344060 Ultra-Clear™ Tubes, 331313 Bucket Holder Rack, and Spare Parts/Supplies — 335148 Vacuum Grease, 306812 Spinkote™ Lubricant, 330335 Overspeed Disk, and 331309 Gaskets for Buckets.

Rotor Assembly: No. 331302. SW 40 Ti Rotor and Bucket Set.

Tubes

Tube Style/Material	Part No.	Quantity	Vol. (mL) g-Max	Size (mm)	Floating Spacers (qty. 1)	Adapters (qty. 1)	g-Force	k Factor	Max. Speed
Quick-Seal® Polyallomer	355537	50	5.9	14 x 47	355534	—	285,000	61	40,000
	355870	50	3.5	14 x 25	355534	—	285,000	35	40,000
	357330*	50	3.5	14 x 25	355534	—	285,000	35	40,000
Quick-Seal konical™ Polyallomer	358650	50	4.0	14 x 48	355534	358154	280,000	57	40,000
	358649	50	8.0	14 x 89	355534	358154	280,000	130	40,000
Polyallomer	331374	50	14.0	14 x 95	—	—	285,000	137	40,000
konical Polyallomer	358120	50	10.0	14 x 89	—†	358154	285,000	124	40,000
Ultra-Clear	344060	50	14.0	14 x 95	—	—	285,000	137	40,000

* To simplify ordering, this g-Max™ Kit includes enough spacers to fill rotor, 50 tubes, and required tools.

† Recommend 354468 Extractor Tool (konical tube adapters).

Note: To help you locate g-Max tubes in the rotor listings, these tubes are highlighted with bold, italic type.

Rotor Replacement Parts

- 330335 Overspeed Disk, 40,000 rpm
- 333761 Overspeed Disk, 36,000 rpm
- 331313 Bucket Holder Rack
- 332400 Rotor Stand
- 333789 Bucket Assembly, Red Titanium, with Caps and Gaskets, matched set of 6
- 331309 Gasket for Bucket
- 331763 Caps, matched set of 6

Adapters/Spacers

355534

358154



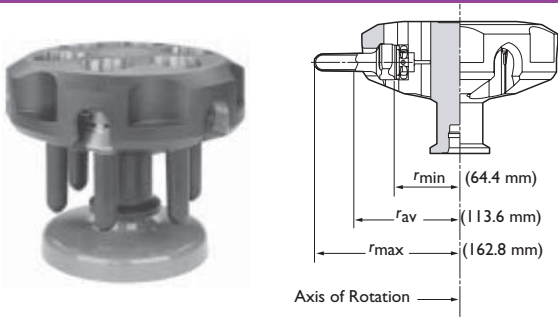

Swinging-Bucket Rotor and Buckets, Titanium

For use in instruments classified: **H R S**

Major applications: Separation of subcellular particles and viruses in density gradients.

Max. RPM	Max. g	k Factor	Number of Tubes Volume/Size	Rotor Capacity
32,000	187,000	228	6 x 17 mL 5/8 x 4 in 16 x 102 mm	102 mL

1

Rotor Package: No. 369696. SW 32.1 Ti Rotor with 2 boxes 337986 Polyallomer Tubes (50 tubes/box), 2 boxes 344061 Ultra-Clear™ Tubes (50 tubes/box), 331186 Bucket Holder Rack, and Spare Parts/Supplies — 306812 Spinkote™ Lubricant, 335148 Vacuum Grease, 335456 Overspeed Disk, 815472 O-rings (qty. 24), and 978354 hooked O-ring Removal Tool.

Rotor Assembly: No. 369651. SW 32.1 Ti Rotor and Bucket Set.

Tubes

Tube Style/Material	Part No.	Quantity	Vol. (mL) g-Max	Size (mm)	Floating Spacers (qty. 1)	Adapters (qty. 1)	g-Force	k Factor	Max. Speed
Quick-Seal®	356291	50	<i>14.5</i>	16 x 102	355579	—	187,000	199	32,000
Polyallomer	344622	50	<i>10.5</i>	16 x 67	355579	—	187,000	133	32,000
Bell-Top	344621	50	<i>8.0</i>	16 x 57	355579	—	187,000	102	32,000
	345830	50	<i>6.5</i>	16 x 44	355579	—	187,000	79	32,000
	356562	50	<i>4.5</i>	16 x 32	355579	—	187,000	56	32,000
Quick-Seal konical™	358653	50	<i>12.5</i>	16 x 102	355579	358155	187,000	205	32,000
Polyallomer Bell-Top									
Polyallomer	337986	50	16.5	16 x 96	—	—	187,000	225	32,000
konical Polyallomer	358123	50	13.5	16 x 93	—	358155	187,000	225	32,000
Ultra-Clear™	344061	50	17	16 x 102	—	—	187,000	228	32,000

To simplify ordering, this g-Max™ Kit includes enough spacers to fill rotor, 50 tubes, and required tools.

Note: To help you locate g-Max tubes in the rotor listings, these tubes are highlighted with bold, italic type.

Rotor Replacement Parts

- 335456 Overspeed Disk, 32,000 rpm
- 332400 Rotor Stand
- 369693 Bucket Set, with Caps and O-rings, set of 6
- 812715 O-ring for Bucket

Extra Buckets for the SW 32.1 Ti

The buckets of the SW 32 can be used with the SW 32.1 rotor head.
369692 Bucket Set, with Caps and O-rings, set of 6

Adapters/Spacers

355579

358155



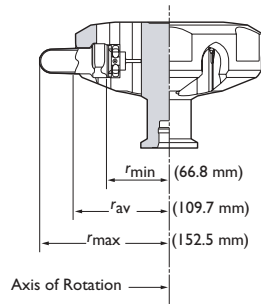

Swinging-Bucket Rotor and Buckets, Titanium

For use in instruments classified: **H R S**

Major applications: Separation of subcellular particles and viruses in density gradients.

Max. RPM	Max. g	k Factor	Number of Tubes Volume/Size	Rotor Capacity
32,000	175,000	204	6 x 38.5 mL 1 x 3.5 in 25 x 89 mm	231 mL

Rotor Package: No. 369694. SW 32 Ti Rotor with Rotor with 2 boxes 326823 Polyallomer Tubes (50 tubes/box), 2 boxes 344058 Ultra-Clear™ Tubes (50 tubes/box), 1 box 355631 Polycarbonate Tubes (50 tubes/box), 331186 Bucket Holder Rack, and Spare Parts/Supplies — 306812 Spinkote™ Lubricant, 335148 Vacuum Grease, 335456 Overspeed Disk, 812715 O-rings (qty. 24), and 978354 hooked O-ring Removal Tool.

Rotor Assembly: No. 369650. SW 32 Ti Rotor and Bucket Set.

Tubes

Tube Style/Material	Part No.	Quantity	Vol. (mL) g-Max	Size (mm)	Floating Spacers (qty. 1)	Adapters (qty. 1)	g-Force	k Factor	Max. Speed
Quick-Seal® Polyallomer Bell-Top	344623 343665 343664	50 50 50	33.5 27.0 15.0	25 x 83 25 x 64 25 x 38	355536 355536 355536	— — —	175,000 175,000 175,000	192 146 81	32,000 32,000 32,000
Quick-Seal konical™ Polyallomer Bell-Top	358651 358654 358652	50 50 50	28.0 22.5 8.4	25 x 83 25 x 76 25 x 38	355536 355536 355536	358156* 358156* 358156*	175,000 175,000 175,000	198 155 74	32,000 32,000 32,000
konical Polyallomer	358126 358125	50 50	31.5 25.5	25 x 89 25 x 76	— —	358156* 358156*	175,000 175,000	156 156	32,000 32,000
Thickwall Polyallomer	355642	50	31.0	25 x 89	—	—	175,000	198	32,000
Thickwall Polycarbonate	355631	50	31.0	25 x 89	—	—	175,000	202	32,000
Ultra-Clear™	344058	50	38.5	25 x 89	—	—	175,000	204	32,000

* Package of 6.

To simplify ordering, this g-Max™ Kit includes enough spacers to fill rotor, 50 tubes, and required tools.

Note: To help you locate g-Max tubes in the rotor listings, these tubes are highlighted with bold, italic type.

Rotor Replacement Parts

- 335456 Overspeed Disk, 32,000 rpm
- 332400 Rotor Stand
- 369692 Bucket Set, with Caps and O-rings, set of 6*
- 812715 O-ring for Bucket

Extra Buckets for the SW 32 Ti

The buckets of the SW 32.1 can be used with the SW 32 rotor head.
369693 Bucket Set, with Caps and O-rings, set of 6

Adapters/Spacers

355579

358155



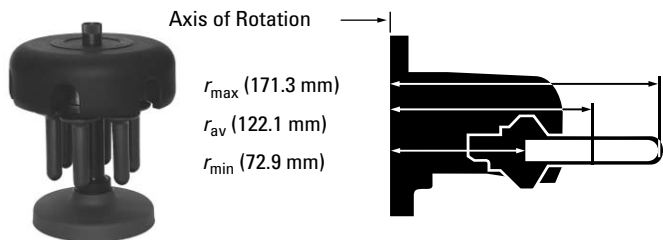

Swinging-Bucket Rotor, Aluminum Head, and Titanium Buckets

For use in instruments classified: **H R S**

Note: Zonal support band (if installed in centrifuge) must be removed before operating this rotor.

Major applications: Rate-zonal centrifugation of subcellular particles and viruses, rate-zonal centrifugation of subcellular fractions.

Max. RPM	Max. g	k Factor	Number of Tubes Volume/Size	Rotor Capacity
28,000	150,000	276	6 × 17 mL 5/8 × 4 in 16 × 102 mm	102 mL

Rotor Package: No. 342214. SW 28.1 Rotor with 2 boxes 337986 Polyallomer Tubes, 2 boxes 344061 Ultra-Clear™ Tubes, 331186 Bucket Holder Rack, and Spare Parts/Supplies — 306812 Spinkote™ Lubricant, 335148 Vacuum Grease, 342211 Overspeed Disk, and 815472 O-rings.

Rotor Assembly: No. 342216. SW 28.1 Rotor and Bucket Set.

Tubes

Tube Style/Material	Part No.	Quantity	Vol. (mL) g-Max	Size (mm)	Floating Spacers (qty. 1)	Adapters (qty. 1)	g-Force	k Factor	Max. Speed
Quick-Seal®	356291	50	18.0	16 × 102	355579	—	150,000	276	28,000
Polyallomer	344622	50	<i>10.0</i>	16 × 67	<i>355579</i>	—	150,000	160	28,000
	344621	50	<i>8.0</i>	16 × 58	<i>355579</i>	—	150,000	134	28,000
	345830	50	<i>6.3</i>	16 × 45	<i>355579</i>	—	150,000	99	28,000
	356562	50	<i>4.2</i>	16 × 32	<i>355579</i>	—	150,000	67	28,000
Quick-Seal konical™ Polyallomer	358653	50	12.5	16 × 102	355579	358155	148,000	276	28,000
Polyallomer	337986	50	17.0	16 × 102	—	—	150,000	276	28,000
konical	358123	50	14.5	16 × 102	—	358155	148,000	276	28,000
Ultra-Clear	344061	50	17.0	16 × 102	—	—	150,000	276	28,000

Note: To help you locate g-Max tubes in the rotor listings, these tubes are highlighted with bold, italic type.

Rotor Replacement Parts

- 330333 Overspeed Disk, 25,000 rpm
- 331186 Bucket Holder Rack
- 332400 Rotor Stand
- 342211 Overspeed Disk, 28,000 rpm
- 342180 Bucket Cap (each)
- 342212 Bucket Assembly, Titanium, with Caps and O-rings, matched set of 6
- 815472 O-ring for Bucket

Extra Buckets for the SW 28.1

The large-volume buckets of the SW 28 can be used with the SW 28.1 rotor head.

- 342217 Bucket Assembly SW 28, Titanium, with Caps and O-rings, matched set of 6

Adapters/Spacers

355579

358155



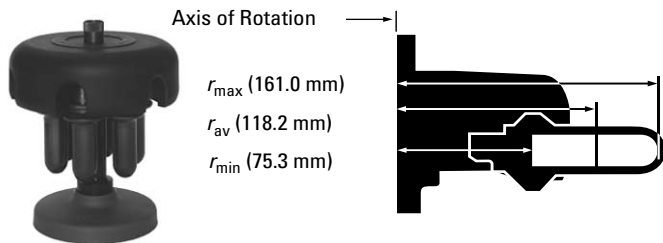

Swinging-Bucket Rotor, Aluminum Head, and Titanium Buckets

For use in instruments classified: **H R S**

Major applications: Differential centrifugation of subcellular fractions and viruses.

Max. RPM	Max. g	k Factor	Number of Tubes Volume/Size	Rotor Capacity
28,000	141,000	246	6 x 39 mL 1 x 3½ in 25 x 89 mm	234 mL

Rotor Package: No. 342204. SW 28 Rotor with 2 boxes 344058 Ultra-Clear™ Tubes, 331186 Bucket Holder Rack, and Spare Parts/Supplies — 306812 Spinkote™ Lubricant, 335148 Vacuum Grease, 342211 Overspeed Disk, and 812715 O-rings.

Rotor Assembly: No. 342207. SW 28 Rotor and Bucket Set.

Tubes

Tube Style/Material	Part No.	Quantity	Vol. (mL) g-Max	Size (mm)	Floating Spacers (qty. 1)	Adapters (qty. 1)	g-Force	k Factor	Max. Speed
Quick-Seal®	344623	50	33.5	25 x 83	355536	—	175,000	192	32,000
Polyallomer	343665	50	27.0	25 x 64	355536	—	175,000	146	32,000
Bell-Top	343664	50	15.0	25 x 38	355536	—	175,000	81	32,000
Quick-Seal	358651	50	28.0	25 x 83	355536	358156*	175,000	198	32,000
konical™	358654	50	22.5	25 x 76	355536	358156*	175,000	155	32,000
Polyallomer	358652	50	8.4	25 x 38	355536	358156*	175,000	74	32,000
Bell-Top									
konical	358126	50	31.5	25 x 89	—	358156*	175,000	156	32,000
Polyallomer	358125	50	25.5	25 x 76	—	358156*	175,000	156	32,000
Thickwall	355642	50	31.0	25 x 89	—	—	175,000	198	32,000
Polyallomer									
Thickwall	355631	50	31.0	25 x 89	—	—	175,000	202	32,000
Polycarbonate									
Ultra-Clear™	344058	50	38.5	25 x 89	—	—	175,000	204	32,000

* Package of 6.

To simplify ordering, this g-Max™ Kit includes enough spacers to fill rotor, 50 tubes, and required tools.

Note: To help you locate g-Max tubes in the rotor listings, these tubes are highlighted with bold, italic type.

Rotor Replacement Parts

- 330333 Overspeed Disk, 25,000 rpm
- 331186 Bucket Holder Rack
- 332400 Rotor Stand
- 342211 Overspeed Disk, 28,000 rpm
- 342217 Bucket Assembly, Titanium, with Caps and O-rings, matched set of 6
- 812715 O-ring for Bucket
- 342179 Bucket Cap (each)

Extra Buckets for the SW 28

The long slender buckets of the SW 28.1 can be used with the SW 28 rotor head.

- 342212 Bucket Assembly SW 28.1, Titanium, with Caps and O-rings, matched set of 6

Adapters/Spacers

355536

358156



Tubes, Caps & Replacement Parts for Discontinued Rotors

Type 16 Fixed-Angle Rotor DISCONTINUED 1999

No Replacement

For use in instruments classified: H R S

Tubes	P/N	Vol.	Size
Polypropylene Bottle	356011	250.0	62 x 122
Polycarbonate Bottle	356013	250.0	62 x 122
Polycarbonate Bottle w/Cap	357000	45.0	29 x 104
Polyallomer Bottle w/Cap	357001	45.0	29 x 104
Polyallomer Bottle/Screw Cap	357003	40.0	29 x 104
Polycarbonate Btl./Screw Cap	357002	40.0	29 x 104
Thickwall Polycarbonate	363664	40.0	29 x 104
Thickwall Polypropylene	357005	40.0	29 x 104
Bio-Vials	566353	4.0	

Replacement Parts:

011757	O-ring for Rotor Handle
347267	Rotor Handle
330331	Overspeed Disk, 19,000 rpm
961072	O-ring for Rotor Lid

Type 21 Fixed-Angle Rotor DISCONTINUED 1999

Recommended Replacement: Type 45 Ti

For use in instruments classified: H R S

Tubes	P/N	Vol.	Size	Caps/Spacer
Polycarbonate Bottle	355620	70.0	38 x 102	326905
Thinwall Polyallomer	345775	94.0	38 x 102	326891
Thickwall Polyallomer	355643	81.0	38 x 102	338903
Thickwall Polycarbonate	355628	81.0	38 x 102	338903
Thinwall Ultra-Clear™	345777	94.0	38 x 102	326891

Replacement Parts:

011757	O-ring for Rotor Handle
347267	Rotor Handle
330331	Overspeed Disk, 19,000 rpm
961072	O-ring for Rotor Lid

Type 28 Fixed-Angle Rotor DISCONTINUED 1999

No Replacement

For use in instruments classified: H R S

Tubes	P/N	Vol.	Size
Polyallomer Bottle w/Cap	357001	45.0	29 x 104
Polyallomer Bottle/Screw Cap	357003	40.0	29 x 104
Polycarbonate Bottle w/Cap	357000	45.0	29 x 104
Thickwall Polycarbonate	363664	40.0	29 x 104
Thickwall Polypropylene	357005	40.0	29 x 104
Polyallomer Tube w/Cap	357448	1.5	11 x 38

Replacement Parts:

011757	O-ring for Rotor Handle
342211	Overspeed Disk, 28,000 rpm
358997	Rotor Handle
870612	O-ring for Rotor Lid
330333	Overspeed Disk, 28,000 rpm
358349	Rotor Lid

Type 40 Fixed-Angle Rotor DISCONTINUED 1997

Recommended Replacement: Type 70.1 Ti

For use in instruments classified: A B C D F G H Q R S

Tubes	P/N	Vol.	Size	Caps/Spacer
Quick-Seal® Polyallomer	342413	13.5	16 x 76	342696
Quick-Seal Ultra-Clear™	344322	13.5	16 x 76	342696
Polycarbonate Bottle	355603	10.4		
Thinwall Polyallomer	326814	13.5	16 x 76	330860
Thickwall Polyallomer	355640	10.0	16 x 76	338907
Thickwall Polycarbonate	355630	10.0	16 x 76	338907
Thinwall Ultra-Clear	344085	13.5	16 x 76	330860

Replacement Parts:

011757	O-ring for Rotor Handle
330335	Overspeed Disk, 40,000 rpm
333761	Overspeed Disk, 36,000 rpm
334967	Rotor Handle
807474	O-ring for Rotor Lid

Type 40.2 Fixed-Angle Rotor DISCONTINUED 1982

Recommended Replacement: Type 50.4 Ti

For use in instruments classified: A B C D F G H N O P Q

Tubes	P/N	Vol.	Size	Caps/Spacer
Ultra-Clear	344088	6.5	13 x 64	346256
Quick-Seal Ultra-Clear	344320	6.0	13 x 64	344389
Polyallomer	326820	6.5	13 x 64	346256
Thickwall Polyallomer	355644	4.0	13 x 64	
Quick-Seal Polyallomer	344619	6.0	13 x 64	344389
Thickwall Polycarbonate	355645	4.0	13 x 64	

Type 50 Fixed-Angle Rotor DISCONTINUED 1997

Recommended Replacement: Type 70.1 Ti

For use in instruments classified: A B C D F G H Q R S

Tubes	P/N	Vol.	Size	Caps/Spacer
OptiSeal™ Polyallomer	361623	8.9	16 x 60	361670
Quick-Seal® Polyallomer	344621	8.0	16 x 58	344634
Polycarbonate Bottle	355615	8.5	16 x 64	
Thinwall Polyallomer	326826	10.0	16 x 64	330860
Thickwall Polyallomer	355646	8.0	16 x 64	338907
Thickwall Polycarbonate	355647	8.0	16 x 64	338907
Thinwall Ultra-Clear™	344089	10.0	16 x 64	330860

Replacement Parts:

011757	O-ring for Rotor Handle
334967	Rotor Handle
330336	Overspeed Disk, 50,000 rpm
335657	Mechanical Overspeed Device, 45,000 rpm
335458	Overspeed Disk, 45,000 rpm
801766	O-ring for Rotor Lid

Tubes, Caps & Replacement Parts for Discontinued Rotors

Type 50 Ti Fixed-Angle Rotor DISCONTINUED 1997

Recommended Replacement: Type 70.1 Ti

For use in instruments classified: B C D F G H Q R S

Tubes	P/N	Vol.	Size	Caps/ Spacer
OptiSeal™ Polyallomer	361623	8.9	16 x 60	361670
Quick-Seal® Polyallomer	342413	13.5	16 x 76	342696
Quick-Seal Ultra-Clear™	344322	13.5	16 x 76	342696
Polyarbonate Bottle	355603	10.4	16 x 76	
Thinwall Polyallomer	326814	13.5	16 x 76	330860
Thickwall Polyallomer	355640	10.0	16 x 76	338907
Thickwall Polycarbonate	355630	10.0	16 x 76	338907
Thinwall Ultra-Clear	344085	13.5	16 x 76	330860

Replacement Parts:

011757	O-ring for Rotor Handle
330336	Overspeed Disk, 50,000 rpm
807474	O-ring for Rotor Lid
326220	Rotor Lid

Type 50.3 Ti Fixed-Angle Rotor DISCONTINUED 1999

Recommended Replacement: type 50.4 Ti

For use in instruments classified: B C D F G H Q R S

Tubes	P/N	Vol.	Size	Caps/ Spacer
OptiSeal™ Polyallomer	361621	4.9	13 x 48	361676
Quick-Seal® Polyallomer	344619	6.0	13 x 64	344389
Quick-Seal Ultra-Clear™	344320	6.0	13 x 64	344389
Thinwall Polyallomer	326820	6.5	13 x 64	346256
Thickwall Polyallomer	355644	4.0	13 x 64	
Thickwall Polycarbonate	355645	4.0	13 x 64	
Thinwall Ultra-Clear	344088	6.5	13 x 64	346256

Replacement Parts:

011757	O-ring for Rotor Handle
330336	Overspeed Disk, 50,000 rpm
343146	Rotor Handle
801767	O-ring for Rotor Lid
326220	Rotor Lid

Type 55.2 Ti Fixed-Angle Rotor DISCONTINUED 1999

Recommended Replacement: Type 70 Ti or 50.2 Ti

For use in instruments classified: G H R S

Tubes	P/N	Vol.	Size	Caps/ Spacer
OptiSeal™ Polyallomer	361625	32.4	25 x 77	361669
Quick-Seal® Polyallomer	342414	39.0	25 x 89	342699
Quick-Seal Ultra-Clear™	344326	39.0	25 x 89	342699
Polyarbonate Bottle	355618	26.3	25 x 89	
Thinwall Polyallomer	326823	38.5	25 x 89	331151
Thickwall Polyallomer	355642	31.0	25 x 89	338906
Thickwall Polycarbonate	355631	31.0	25 x 89	338906
Thinwall Ultra-Clear	344058	38.5	25 x 89	331151

Replacement Parts:

328896	Overspeed Disk, 55,000 rpm
854519	Small O-ring for Rotor Lid
337904	Rotor Handle Assembly
878983	Large O-ring for Rotor Lid
342173	Rotor Lid

Type 60 Ti Fixed-Angle Rotor DISCONTINUED 1997

Recommended Replacement: Type 70 Ti

For use in instruments classified: B F G H R S

Tubes	P/N	Vol.	Size	Caps/ Spacer
OptiSeal™ Polyallomer	361625	32.4	25 x 77	361669
Quick-Seal® Polyallomer	342414	39.0	25 x 89	342699
Quick-Seal Ultra-Clear™	344326	39.0	25 x 89	342699
Polyarbonate Bottle	355618	26.3	25 x 89	
Thinwall Polyallomer	326823	38.5	25 x 89	331151
Thickwall Polyallomer	355642	31.0	25 x 89	338906
Thickwall Polycarbonate	355631	31.0	25 x 89	338906
Thinwall Ultra-Clear	344058	38.5	25 x 89	331151

Replacement Parts:

011757	O-ring for Rotor Handle
331155	Overspeed Disk, 60,000 rpm
858125	O-ring for Rotor Lid
331149	Rotor Lid

Type 65 Fixed-Angle Rotor DISCONTINUED 1997

Recommended Replacement: Type 70.1 Ti

For use in instruments classified: A B C D F G H Q R S

Tubes	P/N	Vol.	Size	Caps/ Spacer
OptiSeal™ Polyallomer	361623	8.9	16 x 60	361670
Quick-Seal® Polyallomer	342413	13.5	16 x 76	342696
Quick-Seal Ultra-Clear™	344322	13.5	16 x 76	342696
Polyarbonate Bottle	355603	10.4	16 x 76	
Thinwall Polyallomer	326814	13.5	16 x 76	330860
Thickwall Polyallomer	355640	10.0	16 x 76	338907
Thickwall Polycarbonate	355630	10.0	16 x 76	338907
Ultra-Clear	344085	13.5	16 x 76	330860

Replacement Parts:

011757	O-ring for Rotor Handle
331155	Overspeed Disk, 60,000 rpm
330338	Overspeed Disk, 65,000 rpm
807474	O-ring for Rotor Lid (if O-ring fits into lip around top of rotor body)
878073	O-ring for Rotor Lid (if O-ring fits onto the lid of the rotor)
334972	Rotor Handle

Type 80 Ti Fixed-Angle Rotor DISCONTINUED 1997

Recommended Replacement: Type 90 Ti

For use in instruments classified: F G H R S

Tubes	P/N	Vol.	Size	Caps/ Spacer
OptiSeal™ Polyallomer	361623	8.9	16 x 60	361670
Quick-Seal® Polyallomer	342413	13.5	16 x 76	342695
Quick-Seal Ultra-Clear™	344322	13.5	16 x 76	342695
Polyarbonate Bottle	355603	10.4	16 x 76	
Thinwall Polyallomer	326814	13.5	16 x 76	341968
Thickwall Polyallomer	355640	10.0	16 x 76	338907
Thickwall Polycarbonate	355630	10.0	16 x 76	338907
Ultra-Clear	344085	13.5	16 x 76	341968

Replacement Parts:

010018	O-ring for Rotor Handle
341965	Overspeed Disk, 80,000 rpm
341967	Rotor Handle
878073	O-ring for Rotor Lid
341964	Rotor Lid

Tubes, Caps & Replacement Parts for Discontinued Rotors

SW 30 Swinging-Bucket Rotor DISCONTINUED 1999

Recommended Replacement: SW 28

For use in instruments classified: B C D F G H R S

Tubes	P/N	Vol.	Size	Caps/ Spacer
Quick-Seal® Polyallomer	343664	15.0	25 x 38	355536
Quick-Seal konical™ Polyallomer	357345	8.5	25 x 38	355536
Thinwall Polyallomer	346599	20.0	25 x 50	
Thickwall Polyallomer	355658	17.5	25 x 50	
Thickwall Polycarbonate	355659	17.5	25 x 50	
Ultra-Clear™	346598	20.0	25 x 50	

Replacement Parts:

330334	Overspeed Disk, 30,000 rpm
331193	Overspeed Disk, 27,000 rpm
331186	Bucket Holder Rack
332400	Rotor Stand
346385	Bucket Assembly, Titanium, with Caps and O-rings, matched set of 6
812715	O-ring for Bucket
346587	Bucket Cap (each)

SW 30.1 Swinging-Bucket Rotor DISCONTINUED 1999

Recommended Replacement: SW 28.1

For use in instruments classified: B C D F G H R S

Tubes	P/N	Vol.	Size	Caps/ Spacer
Quick-Seal® Polyallomer	345830	6.3	16 x 45	355579
Thinwall Polyallomer	346601	8.0	16 x 51	
konical™ Polyallomer	358122	5.5	16 x 51	
Ultra-Clear™	346600	8.0	16 x 51	

Replacement Parts:

330334	Overspeed Disk, 30,000 rpm
331193	Overspeed Disk, 27,000 rpm
331186	Bucket Holder Rack
332400	Rotor Stand
815472	O-ring for Bucket
346588	Bucket Cap (each)

SW 50.1 Swinging-Bucket Rotor DISCONTINUED 1997

Recommended Replacement: SW 55 Ti

For use in instruments classified: A B C D F G H Q R S

Tubes	P/N	Vol.	Size	Caps/ Spacer
OptiSeal™ Polyallomer	361627	3.3	13 x 33	361678
Quick-Seal® Polyallomer	345829	2.0	13 x 25	355535
Quick-Seal konical™ Polyallomer	358647	3.2	13 x 51	355535
Thinwall Polyallomer	326819	5.0	13 x 51	
konical Polyallomer	358119	3.0	13 x 51	
Thickwall Polyallomer	349623	3.5	13 x 51	
Thickwall Polycarbonate	349622	3.5	13 x 51	
Ultra-Clear™	344057	5.0	13 x 51	

Replacement Parts:

330336	Overspeed Disk, 50,000 rpm
335458	Overspeed Disk, 45,000 rpm
331313	Bucket Holder Rack
332400	Rotor Stand
340081	Bucket Assembly, Titanium, with Caps, and O-rings, matched set of 6
824412	O-ring for Bucket

Z-60 Zonal Rotor, Titanium DISCONTINUED 1997

Recommended Replacement: Ti-14

For use in instruments classified: F G H S

Replacement Parts:

331155	Overspeed Disk, 60,000 rpm
335459	Overspeed Disk, 54,000 rpm
336576	Baffle, 4 required
	817035 O-ring, top of Core
	870525 O-ring, in Core Baffle
	4 required
824528	O-ring, top of Bushing in Coupling
829659	O-ring, bottom of Bushing in Coupling
834499	O-ring, bottom of Transfer Shaft
854540	O-ring, middle of Bushing in 0Coupling
870986	O-ring, for Rotor Lid

Tool Kit:

328917	Rotor Tool Kit
332688	Rotor Vise
332690	Spanner Wrench
333763	Tubing Removal Tool
858532	Pliers
337885	Baffle Alignment Tool



See also page 1-2 for factory installation.

Continuous Flow Rotor, Titanium

For use in instruments classified: **HS**

Major applications: Isopycnic banding of viruses.

Max. RPM	Max. g	k Factor	Rotor Capacity
32,000	102,000	42	430 mL

1

CF-32 Ti Rotor Kit

No. **350700** Basic Rotor Kit. Use with L5, L8, or Optima™

No. **350867** CF-32 Rotor (Rotor, Lid, O-ring)

CF-32 Ti Rotor Packages (for field installation of Optima/L8 instruments)

Include: Basic Rotor Kit, Door Kit, Adapter Bowl Assembly, and Vacuum Pump.

354438 CF-32 Rotor Package for Optima, 60 Hz

354439 CF-32 Rotor Package for Optima, 50 Hz

CF-32 Ti Accessories

354474 Door Kit and Hardware for Optima

L/XL Series

358921 Adapter Bowl, Optima/L8

358922 CF-32 Aspirator Vacuum Pump, 120 V

358923 CF-32 Aspirator Vacuum Pump, 220 V

961778 Vibration Mount, Optima (each; 3 needed)

355911 Vibration Mount, L/L2/L3/L5/L8 (set of 3)

354192 Standoff, CF-32 (sold in quantity of 1)

Note: A continuous-output gradient pump able to operate against a backpressure of 20 psi (138 kPa) is also required. The purchased pump must be able to provide a flow of up to 150 mL/min. (9 L/hr) and the pump head must accept 1/8-in. (3-mm) I.D. tubing. We recommend a Masterflex pump that can be purchased directly from the manufacturer:

Barnant Corporation
P.O. Box 510
Barrington, IL 60010
<http://www.barnant.com>

* Masterflex is a registered trademark of Cole-Parmer Instrument Company.

Rotor Replacement Parts

011167	O-ring for Stem Assembly
303636	Backup Washer (red fiber)
328946	Gasket for Rotor Lid
328949	Non-extrusion Ring
335222	Vane for Core
335303	Core Handle
335456	Overspeed Disk 32K
344658	Adapter Bowl O-ring
354680	Septa Assembly
807446	Fitting, Stainless Steel
841687	Small O-ring in Stem Assembly

Seal Assembly Replacement Parts

008025	O-ring under Rotating Seal (large)
010177	O-ring in Static Seal Assembly (medium)
011920	O-ring in Static Seal Assembly (small)
010426	O-ring in Rotating Seal (small)
020198	O-ring in Bearing Base
335233	Adapter Bowl Flat Gasket/Pad
354460	Static Seal Assembly
354458	Rotating Seal
853156	O-ring in Static Seal Assembly (large)
870030	Spring in Manifold
870315	O-ring in Manifold
354307	CF-32 Stem Assembly/Bearing Kit: Includes a matched and serialized set of Stem Holder Assembly and Bearing Assembly.

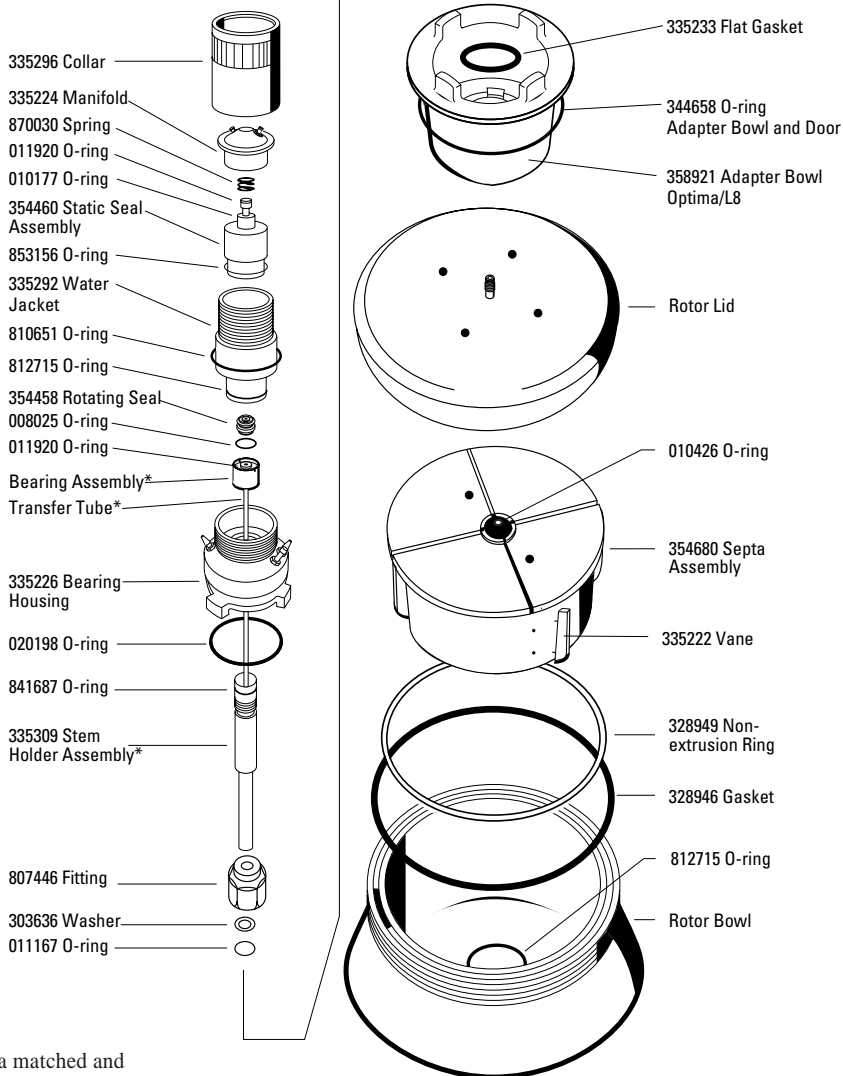

* Available only as part of Stem Assembly/Bearing Kit, P/N 354307.

Note: The CF-32 Ti Rotor cannot be used in Beckman Coulter ultracentrifuges that have been modified with the Prep UV-Scanner or Schlieren accessories.



Zonal Rotor, Titanium

For use in instruments classified: **H S**

Major applications: Rate-zonal centrifugation of subcellular particles.

Max. RPM	Max. g	Rotor Capacity	Typical Sample Volume	Particle Pathlength
32,000	102,000	1,675 mL	50-200 mL	7.5 cm

Note: Solutions in the pH range of 4 to 10 can be used in this Titanium rotor.

No. 969312 Type Ti-15 Titanium Zonal Rotor and Lid with Standard Core

No. 969313 Type Ti-15 Titanium Zonal Rotor and Lid with B29 Core

No. 369622 Type Ti-15 Titanium Zonal Rotor and Lid without Core

All above include 332676 Push-Pull Cap and Spare Parts/Supplies – 335148 Vacuum Grease, 306812 Spinkote™ Lubricant, 2 extra 335456 Overspeed Disks, and O-rings. (Seal Assembly, Mounting Hardware, and Tool Kit also required.)

Note: A continuous-output gradient pump able to operate against a backpressure of 20 psi (138 kPa) is also required. The purchased pump must be able to provide a flow of up to 50 mL/min. (3 L/hr) and the pump head must accept 1/8-in. (3-mm) I.D. tubing. We recommend a Masterflex pump that can be purchased directly from the manufacturer:

Barnant Corporation
P.O. Box 510
Barrington, IL 60010
<http://www.barnant.com>

* Masterflex is a registered trademark of Cole-Parmer Instrument Company.

Replacement Parts for the Ti-15 Rotor and the Discontinued Al-15 Rotor

328946	Rotor Gasket
328949	Non-extrusion Ring
332676	Push-Pull Cap
333857	Rotor Core, Noryl
	815472 O-ring, top of Rotor Core
	011167 O-ring for Seal Fitting
	812715 O-ring, bottom of Rotor Core
	332682 Cone
	011519 O-ring, interior of Cap
	332691 Seal Fitting
	012780 O-ring, visible, on Cap
335456	Ti-15 Overspeed Disk, 32,000 rpm
336821	Ti-15 Overspeed Disk, 29,000 rpm

Tool Kits/Additional Parts

328917	Rotor Tool Kit	354192	Standoff (qty. 3 req'd for field installations)
332688	Rotor Vise		
332690	Spanner Wrench	961778	Vibe Mount (qty. 3 req'd for field installations)
333763	Tubing Removal Tool		
858532	Pliers		

B-29 Type Core for Al/Ti-15 Rotors

No. 350474. This core for introduction of sample solution and recovery of fractions from the edge as well as the center of the zonal rotor is readily interchangeable with the standard cores. The ability to load the zonal rotor from the edge can greatly facilitate flotation-type runs. Also isopycnic banding in cesium chloride can be economically extended to Titanium zonal rotors with the B-19 Type core.

Reograd Type Core

No. 350552. Gradient is loaded and unloaded while rotor is at rest. Gradient reorients during acceleration and reorients upon deceleration. Does not require zonal seal assembly or mounting hardware. The rotor is loaded using a special cap (supplied with the core) with inlet and outlet. The cap is replaced with the standard rotor cap for the run. This core is particularly useful for lipoprotein subfractionation.

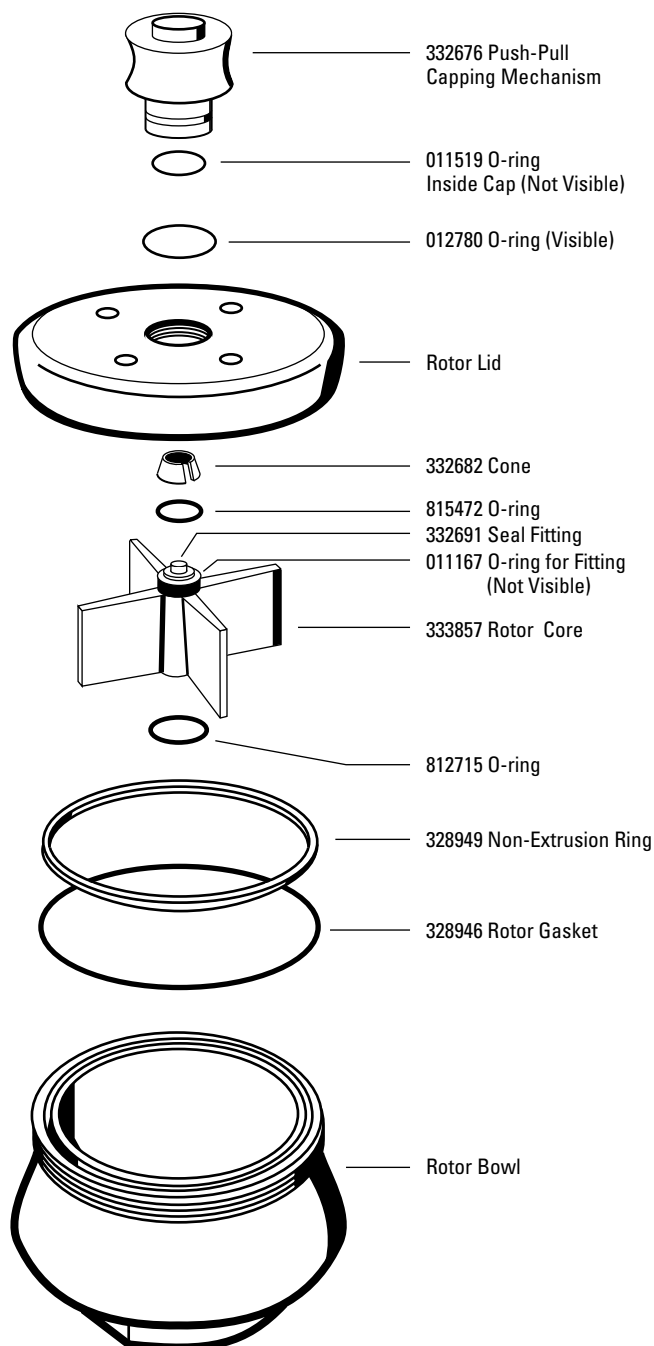



Zonal Rotor, Titanium

For use in instruments classified: **H S**

Major applications: Rate-zonal centrifugation of subcellular particles, rate-zonal flotation of lipoproteins.

Max. RPM	Max. g	Rotor Capacity	Typical Sample Volume	Particle Pathlength
48,000	172,000	665 mL	20-50 mL	5.3 cm

Note: Solutions in the pH range of 4 to 10 can be used in this Titanium rotor.

No. 328911 Type Ti-14 Titanium Zonal Rotor and Lid with Noryl Core

No. 392048 Type Ti-14 Titanium Zonal Rotor and Lid without Core

All above include 332676 Push-Pull Cap and Spare Parts/Supplies – 335148 Vacuum Grease, 306812 Spinkote™ Lubricant, 2 extra 332619 Overspeed Disks, and O-rings. (Seal Assembly, Mounting Hardware, and Tool Kit also required.)

Note: A continuous-output gradient pump able to operate against a backpressure of 20 psi (138 kPa) is also required. The purchased pump must be able to provide a flow of up to 25 mL/min. (1.5 L/hr) and the pump head must accept 1/8-in. (3-mm) I.D. tubing. We recommend a Masterflex pump that can be purchased directly from the manufacturer:

Barnant Corporation
P.O. Box 510
Barrington, IL 60010
<http://www.barnant.com>

* Masterflex is a registered trademark of Cole-Parmer Instrument Company.

Replacement Parts for the Ti-14 Rotor and The Discontinued Al-14 Rotor

328945	Rotor Gasket
328948	Non-extrusion Ring
332676	Push-Pull Cap
332682	Cone
333856	Rotor Core, Noryl
	815472 O-ring, top of Rotor Core
	011167 O-ring for Seal Fitting
	858506 O-ring, bottom of Rotor Core
	332691 Seal Fitting
	011519 O-ring, interior of Cap
	012780 O-ring, visible, on Cap
330329	Ti-14 Overspeed Disk, 42,000 rpm
332619	Ti-14 Overspeed Disk, 48,000 rpm
332620	Ti-14 Overspeed Disk, 35,000 rpm

Tool Kits

328917	Rotor Tool Kit
332688	Rotor Vise
332690	Spanner Wrench
333763	Tubing Removal Tool
858532	Pliers

B-29 Type Core for Ti-14 Rotors

No. 350473. This core for introduction of sample solution and recovery of fractions from the edge as well as the center of the zonal rotor is readily interchangeable with the standard cores. The ability to load the zonal rotor from the edge can greatly facilitate flotation-type runs. Also, isopycnic banding in cesium chloride can be economically extended to Titanium zonal rotors with the B-29 Type Core.

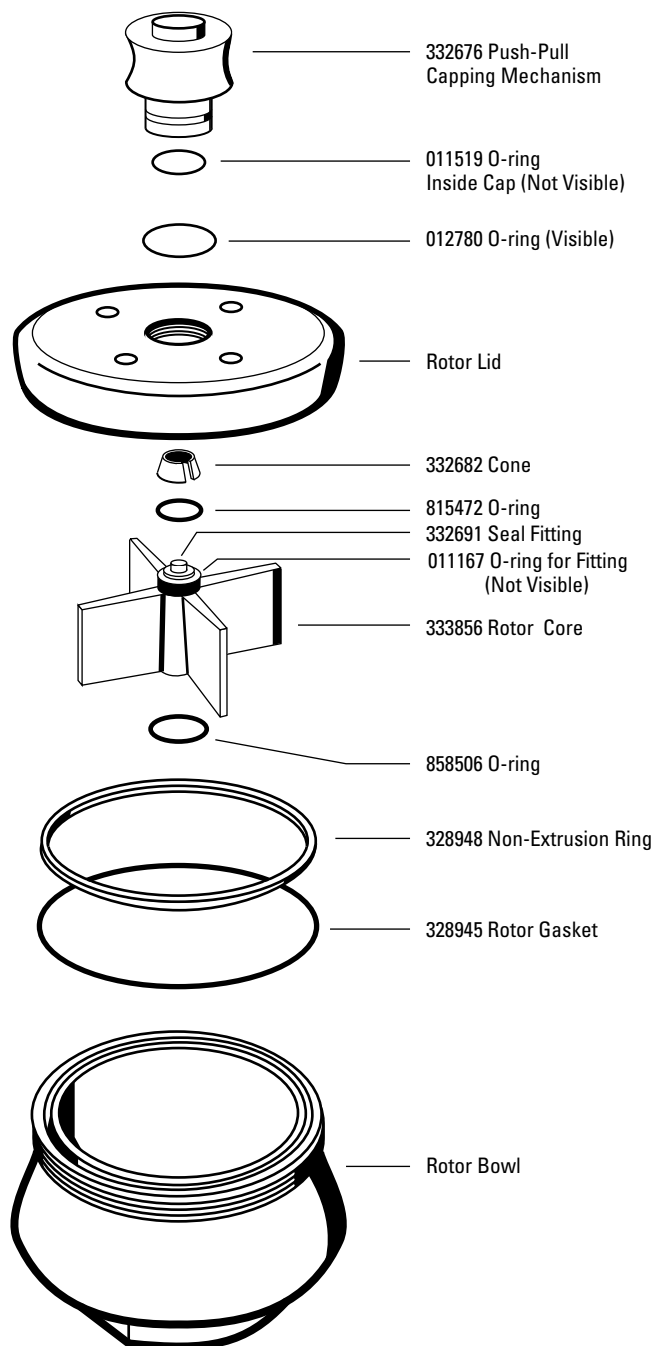



For Zonal Rotors

For use in instruments classified: S

The Seal Assembly holds the lines through which fluids are introduced and withdrawn while the rotor is spinning at 2000 rpm. The assembly may be used with any of the Beckman Coulter zonal rotors in any Beckman Coulter preparative ultracentrifuge.

An order of a Seal Assembly should include three part numbers:

1. Seal Assembly, 334241
2. Tool Kit, 328917
3. Appropriate Mounting Hardware

If the Seal Assembly is to be used in more than one instrument, Mounting Hardware should be ordered for each instrument. If a Z-60 Rotor is to be run in an instrument in which the Ti-14 Rotor will be used, the 336830 Support Band Kit also should be ordered (no charge).

Important Reminder: Seal Assemblies for earlier zonal rotors cannot be used with the new rotors. To distinguish the new Seal Assembly from the earlier version, check the rotating and stationary seals; in the newer assembly, both seals are contained in a single unit, in the manifold assembly (see diagram).

Mounting Hardware

337890 Hardware for any L8M, L8, Optima™ XL

Optimas with Ti 15 rotors require each of the following parts:

- 345192 Standoff (quantity required: 3)
- 961778 Vibe Mount (quantity required: 3)

We recommend the Cole Parmer #7520-40 Pump with #7015-21 Pump Head which can be purchased directly from the manufacturer:

Barnant Corporation
 P.O. Box 510
 Barrington, IL 60010
 Internet address: <http://www.barnant.com>

Installation Requirements

The Mounting Hardware will be installed by a Beckman Coulter Service Representative at no extra cost. In addition to the Gradient Pump, the following installation necessities not supplied by Beckman Coulter are needed: a syringe (50 or 100 mL) for introducing sample, and two hemostats or other clamping devices to shut off tubing lines when necessary.

Replacement Parts for Seal Assembly

- | | |
|--------|--|
| 011167 | O-ring, top of Stationary Seal |
| 328951 | Rotating Rulon Seal, for Seal Assembly |
| 328952 | Stationary Seal, two-piece construction |
| 332618 | Seal Disassembly Tool |
| 333743 | Bearing and Assembly |
| 802173 | Washer, for Bearing Cup |
| 811656 | O-ring, outer perimeter, Stationary Seal |
| 819527 | O-ring, for Bearing Assembly |
| 824412 | O-ring, center top of Stationary Seal |
| 828628 | Screw, for Bearing Cup |
| 868638 | O-ring, for Rotating Seal (set of 4) |
| 858505 | Spring, for Seal Assembly |
| 328954 | Manifold |

Tool Kits

- | | |
|--------|---------------------|
| 328917 | Rotor Tool Kit |
| 332688 | Rotor Vise |
| 332690 | Spanner Wrench |
| 333763 | Tubing Removal Tool |
| 858532 | Pliers |

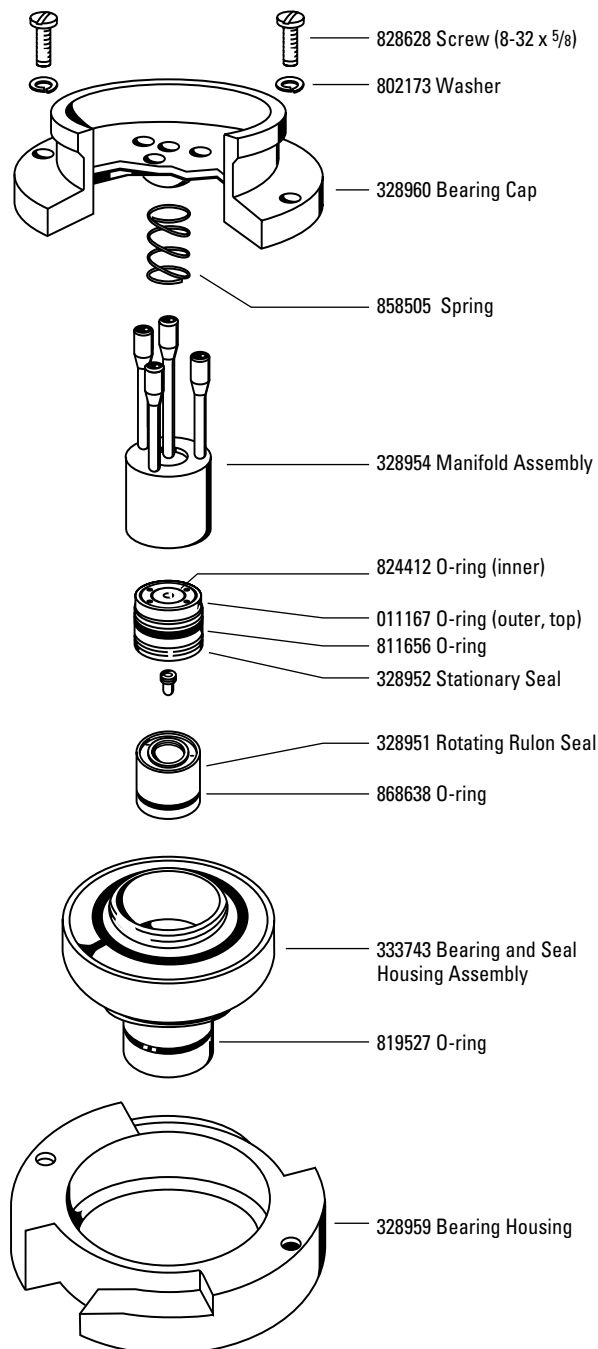

Quick-Reference Guide to Rotor Specifications and Micro-Ultracentrifuge Compatibility

Rotor	Max. RPM	Max. g	k Factor	No. of Tubes x Nominal Tube Volume (mL)	Nominal Rotor Capacity (mL)	For Use in Instruments
TLA-120.2	120,000	627,000	16	10 x 2.0	20	TL-100, Optima™ TL, Optima TLX personal micro-ultracentrifuge, Optima MAX, Optima MAX-E
TLA-120.1	120,000	627,000	8	14 x 0.5	7	TL-100, Optima™ TL, Optima TLX personal micro-ultracentrifuge, Optima MAX, Optima MAX-E
TLA-110	110,000	657,000	13	8 x 5.1	40.8	TL-100, Optima™ TL, Optima TLX personal micro-ultracentrifuge, Optima MAX, Optima MAX-E
TLA-100.3	100,000	541,000	14	6 x 3.5	21	TL-100, Optima™ TL, Optima TLX personal micro-ultracentrifuge, Optima MAX, Optima MAX-E
TLA-100	100,000	436,000	7	20 x 0.2	4	TL-100, Optima™ TL, Optima TLX personal micro-ultracentrifuge, Optima MAX, Optima MAX-E
TLA-55	55,000	186,000	66	12 x 1.5	18	TL-100, Optima™ TL, Optima TLX personal micro-ultracentrifuge, Optima MAX, Optima MAX-E
TLS-55	55,000	259,000	50	4 x 2.2	8.8	TL-100, Optima™ TL, Optima TLX personal micro-ultracentrifuge, Optima MAX, Optima MAX-E
TLN-120	120,000	585,000	7	8 x 1.2	9.6	TL-100, Optima™ TL, Optima TLX personal micro-ultracentrifuge, Optima MAX, Optima MAX-E
TLN-100	100,000	450,000	14	8 x 3.9	31.2	TL-100, Optima™ TL, Optima TLX personal micro-ultracentrifuge, Optima MAX, Optima MAX-E
TLV-100	100,000	400,000	9	8 x 2.0	16	TL-100, Optima™ TL, Optima TLX personal micro-ultracentrifuge, Optima MAX, Optima MAX-E
MLA-130	130,000	1,019,000	8.7	10 x 2.0	20	Optima™ MAX, Optima MAX-E
MLA-80	80,000	444,000	29	8 x 8	64	Optima™ MAX, Optima MAX-E
MLS-50	50,000	268,000	71	4 x 5	20	Optima™ MAX, Optima MAX-E
MLN-80	80,000	389,000	20	8 x 8	64	Optima™ MAX, Optima MAX-E
A-110	110,000	199,000	9	6 x 180 µL	1,080 µL	Airfuge®
A-100/30	92,000	167,000	19	6 x 240 µL	1,440 µL	Airfuge
A-100/18	95,000	148,000	12	6 x 175 µL	1,050 µL	Airfuge
A-95	95,000	178,000	19	4 x 450 µL	1,800 µL	Airfuge
ACR-90	90,000	122,000	45	NA	3.5 mL	Airfuge
Batch Rotor	90,000	132,000	55	NA	7 mL	Airfuge
EM-90	90,000	118,000	NA	6 x 100 µL	600 µL	Airfuge

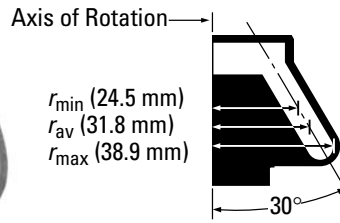

Fixed-Angle Rotor, Titanium

For use in the TL-100, Optima™ TL, Optima TLX personal micro-ultracentrifuges, and Optima MAX high-capacity personal micro-ultracentrifuges.

Note: Non-precipitating solutions up to 1.7 g/mL in density can be run in this rotor without a reduction in rotor speed.

Major applications: Pelleting of subcellular fractions in 5-30 minutes, plasmid DNA separation in 3 hours.

Max. RPM	Max. g	k Factor	Number of Tubes Volume/Size	Rotor Capacity
120,000	627,000	16	10 x 2.0 mL 11 x 34 mm	20 mL

No. 362046. TLA-120.2 Fixed-Angle Rotor Assembly.

No. 357656. TLA-120.2 Fixed-Angle Rotor Package. Includes Rotor, 1 box 343778 Thickwall Polycarbonate Tubes, 348305 Tube Rack, 346133 Rotor Vise/Stand, 927208 Hemostats, 824412 and 854519 O-rings, 306812 Spinkote™ Lubricant, and 355148 Vacuum Grease.

Tubes and Bottles

Tube Style/Material	Part No.	Quantity	Vol. (mL) g-Max	Size (mm)	Floating Spacers (qty. 1)	Adapters (qty. 1)	g-Force	k Factor	Max. Speed
Quick-Seal® Polyallomer	344625	50	2.0	11 x 32	344674	—	627,000	16	120,000
	344624	50	<i>1.5</i>	11 x 25	344636	—	627,000	14	120,000
Thickwall Polyallomer	347287	100	1.0	11 x 34	—	—	279,000	18	80,000
Thickwall Polycarbonate	343778	100	1.0	11 x 34	—	—	627,000	8	120,000

Note: To help you locate g-Max tubes in the rotor listings, these tubes are highlighted with bold, italic type.

Rotor Accessories

- 301875 Spacer Removal Tool
- 348305 Tube Rack for 11-mm Tubes (included with Rotor Package)
- 349487 Quick-Seal Tube Rack (Tube Rack Adapters required)
- 362100 Tube Rack Adapter (set/8) for sealing Tubes 344624
- 362101 Tube Rack Adapter (set/8) for sealing Tubes 344625
- 346133 Rotor Vise Assembly
- 349387 Tube Topper Rack for 11-mm Tubes
- 927208 Hemostats, 6-in. curved
- 345531 Quick-Seal Starter Kit, 11 x 25 mm, 2.0 mL Tubes. Includes 10 each 344636 Spacers, box of 344624 Tubes and 8 each Adapters. 349487 Tube Rack required.
- 345532 Quick-Seal Starter Kit, 11 x 32 mm, 2.0 mL Tubes. Includes 10 each 344674 Spacers, box of 344625 Tubes and 8 each 344644 Adapters. 349487 Tube Rack required.

Rotor Replacements Parts

- 362048 Rotor Lid Assembly
- 854519 O-ring (outer, Rotor Lid)
- 824412 O-ring (inner, Rotor Lid)
- 349318 Cap & Plunger Assembly

Adapters/Spacers

344636 344674



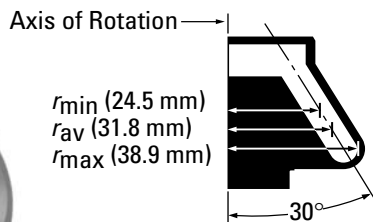

Fixed-Angle Rotor, Titanium

For use in the TL-100, Optima™ TL, Optima TLX personal micro-ultracentrifuges, and Optima MAX high-capacity personal micro-ultracentrifuges.

Major applications: Pelleting of subcellular fractions in 5-30 minutes; plasmid DNA separation in 3 hours.

Max. RPM	Max. g	k Factor	Number of Tubes Volume/Size	Rotor Capacity
120,000	627,000	8	14 x 0.5 mL 8 x 34 mm	7 mL

No. 362224. TLA-120.1 Fixed-Angle Rotor Assembly.

No. 357655. TLA-120.1 Fixed-Angle Rotor Package. Includes Rotor, 1 box 343776 Thickwall Polycarbonate Tubes, 348304 Tube Rack, 346133 Rotor Vise/Stand, 927208 Hemostats, 824412 and 854519 O-rings, 306812 Spinkote™ Lubricant, and 355148 Vacuum Grease.

Tubes and Bottles

Tube Style/Material	Part No.	Quantity	Vol.(mL)	Size g-Max	Floating (mm)	Adapters Spacers	g-Force	k Factor	Max. Speed
Thickwall Polyallomer	343777	100	0.5	8 x 34	—	—	279,000	18	80,000
Thickwall Polycarbonate	343776	100	0.5	8 x 34	—	—	627,000	8	120,000

Rotor Accessories

- 348305 Tube Rack for 8-mm Tubes (included with Rotor Package)
- 927208 Hemostats
- 346133 Rotor Vise/Stand
- 347404 Rotor Cleaning Brush

Rotor Replacement Parts

- 363335 Rotor Lid Assembly (O-rings not included)
- 854519 O-ring (outer, Rotor Lid)
- 824412 O-ring (inner, Rotor Lid)
- 349318 Cap & Plunger Assembly



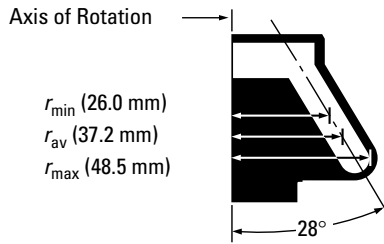

Fixed-Angle Rotor, Titanium

For use in the TL-100, Optima™ TL, Optima TLX personal micro-ultracentrifuges, and Optima MAX Ultracentrifuges.

Major applications: Moderate volume differential sedimentation (pelleting) of subcellular organelles and viruses.

Max. RPM	Max. g	k Factor	Number of Tubes Volume/Size	Rotor Capacity
110,000	657,000	13	8 x 5.1 mL 13 x 56 mm	40.8 mL

1

No. 366735. TLA-110 Fixed-Angle Rotor Package. Includes Rotor, one box of 361621 OptiSeal™ Tubes, eight each 361676 Floating Spacers, 854519 and 824412 O-ring, 348122 Rack Assembly, 927208 Hemostats, 306812 Spinkote™ Lubricant, and 335148 Vacuum Grease.

No. 366730. TLA-110 Fixed-Angle Rotor Assembly.

Tubes and Bottles

Tube Style/Material	Part No.	Quantity	Vol. (mL) g-Max	Size (mm)	Floating Spacers (qty. 1)	Adapters (qty. 1)	g-Force	k Factor	Max. Speed
OptiSeal™ Polyallomer Bell Top	361621	56	4.7	13 x 48	361676	—	657,000	12	110,000
Quick-Seal® Polyallomer Bell Top	362248	50	5.1	13 x 51	362307	—	657,000	13	110,000
	349621	50	3.5	13 x 32	360270	—	657,000	7	110,000
	345829	50	2.0	13 x 25	360270	—	657,000	5	110,000
Thickwall Polyallomer	362333	50	3.2	13 x 56	—	—	267,000	37	70,000
Thickwall Polycarbonate	362305	50	3.2	13 x 56	—	—	657,000	13	110,000
Microcentrifuge Polyallomer	357448	500	1.5	11 x 39	—	360951	206,000	19	70,000

* Package of eight.

Rotor Accessories

- 338765 Spacer Removal Tool for 3.5-mL and 2.0-mL Quick-Seal Tube Spacers
- 355872 Tube Rack for 13-mm Tubes (included in Rotor Package)
- 348122 Tube Topper Rack for 13-mm Tubes
- 349487 Tube Rack for g-Max® Quick-Seal Tubes
- 355582 Tube Rack Adapter for 13 x 32 mm, 3.5-mL Quick-Seal Tubes for use in 349487 Tube Rack
- 345832 Tube Rack Adapter for 13 x 25 mm, 2.0-mL Quick-Seal Tubes for use in 349487 Tube Rack
- 347404 Rotor Cleaning Brush
- 927208 Hemostats, 6-in. curved

Rotor Replacement Parts

- 854519 O-ring (outer, Rotor Lid)
- 824412 O-ring (inner, Rotor Lid)
- 349477 Cap & Plunger Assembly

Adapters/Spacers

360270 360951 361676 362307



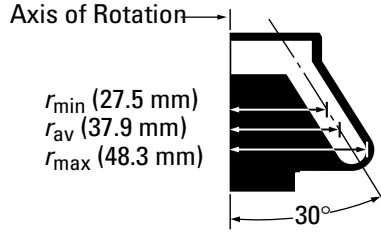

Fixed-Angle Rotor, Titanium

For use in the TL-100, Optima™ TL, Optima TLX personal micro-ultracentrifuges, and Optima MAX high-capacity personal micro-ultracentrifuges.

Note: Non-precipitating solutions up to 1.7 g/mL in density can be run in this rotor without a reduction in rotor speed.

Major applications: Pelleting of subcellular fractions in 5-30 minutes; pelleting RNA in 1-2 hours; plasmid DNA separation in 6 hours.

Max. RPM	Max. g	k Factor	Number of Tubes Volume/Size	Rotor Capacity
100,000	541,000	14	6 x 3.5 mL 13 x 51 mm	21 mL

No. 349481. TLA-100.3 Fixed-Angle Rotor Assembly.

No. 349490. TLA-100.3 Fixed-Angle Rotor Package. Includes Rotor, 1 box 349622 Thickwall Polycarbonate Tubes, 1 box 349623 Thickwall Polyallomer Tubes, 1 each 355919 pkg. of 6 Spacers for 1.5 mL Microcentrifuge Tubes, 355872 Tube Rack, 824412 and 854521 O-rings, 927208 Hemostats, 346133 Rotor Vise/Stand, 306812 Spinkote™ Lubricant, and 335148 Vacuum Grease.

Tubes and Bottles

Tube Style/Material	Part No.	Quantity	Vol. (mL)	Size (mm)	Required Caps/ Spacers (qty. 1)	Required Adapters (qty. 1)	g-Force	k Factor	Max. Speed
Quick-Seal® Polyallomer	349621	50	3.5	13 x 32	355937	—	541,000	14	100,000
	345829	50	2.0	13 x 25	360270	—	541,000	11	100,000
Thickwall Polyallomer	349623	25	3.0	13 x 51	—	—	265,000	34	70,000
Thickwall Polycarbonate	349622	25	3.0	13 x 51	—	—	541,000	16	100,000
Microcentrifuge Polyallomer	357448	500	1.5	11 x 38	—	355919	245,000	24	70,000

Note: To help you locate g-Max tubes in the rotor listings, these tubes are highlighted with bold, italic type.

Rotor Accessories

- 338765 Spacer Removal Tool for 3.5-mL and 2.0-mL Quick-Seal Tube Spacers
- 355872 Tube Rack for 13-mm Tubes (included in Rotor Package)
- 348122 Tube Topper Rack for 13-mm Tubes
- 349487 Tube Rack for Quick-Seal Tube Sealer, 8-place (Adapters required)
- 355582 Tube Rack Adapter for 13 x 32 mm, 3.5-mL Quick-Seal Tubes for use in 349487 Tube Rack
- 345832 Tube Rack Adapter for 13 x 25 mm, 2.0-mL Quick-Seal Tubes for use in 349487 Tube Rack
- 347404 Rotor Cleaning Brush

Rotor Replacement Parts

- 349478 Rotor Lid Assembly
- 354443 CentriTube Slicer Adapter for 13-mm Tubes
- 854521 O-ring (outer, Rotor Lid)
- 824412 O-ring (inner, Rotor Lid)
- 349477 Cap & Plunger Assembly

Adapters/Spacers

355919 355937 360270



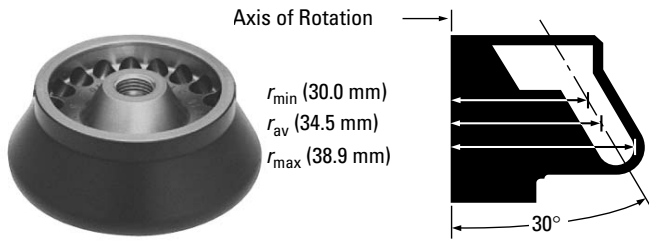

Fixed-Angle Rotor, Titanium

For use in the TL-100, Optima™ TL, Optima TLX personal micro-ultracentrifuges, and Optima MAX high-capacity personal micro-ultracentrifuges.

Note: Non-precipitating solutions up to 1.7 g/mL in density can be run in this rotor without a reduction in rotor speed.

Major applications: Pelleting of subcellular fractions; proteins; RNA.

Max. RPM	Max. g	k Factor	Number of Tubes Volume/Size	Rotor Capacity
100,000	436,000	7	20 x 0.2 mL 7 x 20 mm	4 mL

No. 343840. TLA-100 Fixed-Angle Rotor Assembly.

No. 343837. TLA-100 Fixed-Angle Rotor Package. Includes Rotor, 1 box 343775 Thickwall Polycarbonate Tubes, 348302 Tube Rack, 824412 and 824953 O-rings, 927208 Hemostats, 346133 Rotor Vise/Stand, 306812 Spinkote™ Lubricant, and 335148 Vacuum Grease.

Tubes and Bottles

Tube Style/Material	Part No.	Quantity	Vol.(mL)	Size g-Max	Floating (mm)	Adapters Spacers (qty. 1)	g-Force (qty. 1)	k Factor	Max. Speed
Thickwall Polyallomer	343621	100	0.2	7 x 20	—	—	279,000	10	80,000
Thickwall Polycarbonate	343775	100	0.2	7 x 20	—	—	436,000	7	100,000
Thickwall Cellulose Propionate	342303	100	0.2	7 x 20	—	—	184,000	16	65,000

Rotor Accessories

- 348302 Tube Rack for 7-mm Tubes (included with Rotor Package)
- 927208 Hemostats, 6-in. curved
- 347404 Rotor Cleaning Brush
- 346133 Rotor Vise/Stand

Rotor Replacement Parts

- 824953 O-ring (outer, Rotor Lid)
- 824412 O-ring (inner, Rotor Lid)
- 343845 Rotor Lid Assembly (O-rings not included)
- 349318 Cap & Plunger Assembly

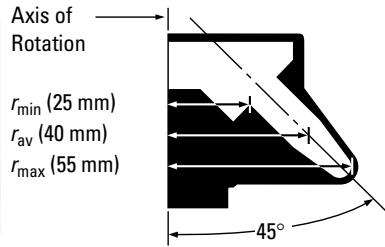

Fixed-Angle Rotor, Aluminum

For use in the TL-100, Optima™ TL, Optima TLX personal micro-ultracentrifuges, and Optima MAX Ultracentrifuges.

Major applications: Rapid pelleting of nucleic acid precipitates in 1.5 mL tubes.

Max. RPM	Max. g	k Factor	Number of Tubes Volume/Size	Rotor Capacity
55,000	186,000	66	12 x 1.5 mL 11 x 38 mm	18 mL

1

No. 366725. TLA-55 Fixed-Angle Rotor Package. Includes Rotor, one box of 500 each 357448 Tubes, 824412 and 824644 O-ring, 348122 Rack Assembly, 927208 Hemostats, 306812 Spinkote™ Lubricant and 335148 Vacuum Grease.

No. 366720. TLA-55 Fixed-Angle Rotor Assembly.

Tubes and Bottles

Tube Style/Material	Part No.	Quantity	Vol. (mL)	Size (mm)	Required Caps/ Spacers (qty. 1)	Required Adapters* (qty. 1)	g-Force	k factor	Max. Speed
Microcentrifuge Polyallomer	357448	500	1.5	11 x 39	—	—	186,000	66	55,000

*Package of eight.

Rotor Accessories

347404 Rotor Cleaning Brush

Rotor Replacement Parts

366722 Rotor Lid Assembly
 824644 O-ring (Outer, Rotor Lid)
 824412 O-ring (Inner, Rotor Lid)
 349318 Cap & Plunger Assembly

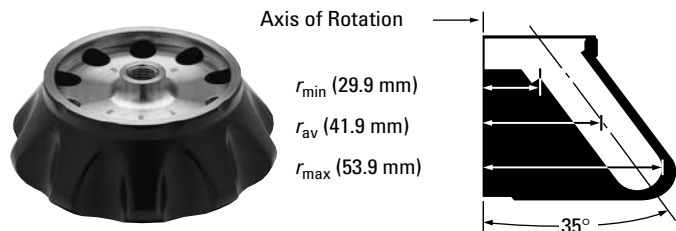

Fixed-Angle Rotor, Titanium

For use in the Optima™ MAX Ultracentrifuges.

Major applications: Rapid differential sedimentation (pelleting) of small particles such as subcellular organelles and viruses.

Max. RPM	Max. g	k Factor	Number of Tubes	Rotor Capacity Volume/Size
130,000	1,019,000	8.7	10 x 2.0 mL 11 x 32 mm	20 mL

No. 367114. MLA-130 Fixed-Angle Rotor Package. Includes Rotor, one box of 50 each 344625 Polyallomer Quick-Seal® Tubes, 367310 Spacer, 348305 Tube Rack, 975001 O-ring, 927208 Hemostats, 306812 Spinkote™ Lubricant and 335148 Vacuum Grease.

No. 367120. MLA-130 Fixed-Angle Rotor Assembly.

Rotor Replacement Parts

346133 Rotor Vise

Tubes and Bottles

Tube Style/Material	Part No.	Quantity	Vol. (mL)	Size (mm)	Floating Spacers (qty. 1)	Adapters (qty. 1)	g-Force	k factor	Max. Speed
Quick-Seal® Polyallomer	344625	50	2.0	11 x 32	367310	—	1,019,000	8.7	130,000
	344624	50	1.5	11 x 25	367310	—	1,019,000	7.0	130,000
Thickwall Polyallomer	347287	100	1.0	11 x 34	—	—	390,000	23	80,000
Thickwall Polycarbonate	343778	50	1.0	11 x 34	—	—	1,019,000	5.8	130,000

Rotor Replacement Parts

367116 Rotor Lid
975001 O-ring for Lid

Adapters/Spacers

367310



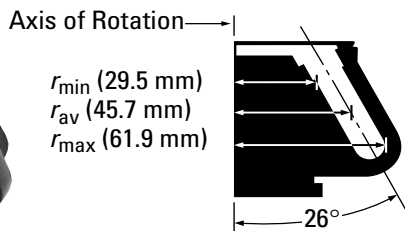

Fixed-Angle Rotor, Titanium

For use in instruments classified: **Optima™ MAX High-Capacity Personal Micro-Ultracentrifuges**

Major applications: Large volume differential sedimentation (pelleting) of subcellular organelles and viruses.

Max. RPM	Max. g	k Factor	Number of Tubes Volume/Size	Rotor Capacity
80,000	444,000	29	8 x 8 mL 16 x 64 mm	64 mL

No. 367096. MLA-80 Fixed-Angle Rotor Package. Includes Rotor, one box of 50 each 344621 Tubes, 367094 Quick-Seal® Bell Top Spacer, 892292 O-ring, 348123 Tube Rack, 927208 Hemostats, 338765 Stem Lifter, 306812 Spinkote™ Lubricant and 335148 Vacuum Grease.

No. 367087. MLA-80 Fixed-Angle Rotor Assembly.

Rotor Replacement Parts

892292 O-ring

Tubes and Bottles

Tube Style/Material	Part No.	Quantity	Vol. (mL)	Size (mm)	Required Caps/ Spacers (qty. 1)	Required Adapters (qty. 1)	g-Force	k factor	Max. Speed
Quick-Seal® Polyallomer	344621	50	8.0	16 x 58	367094	—	444,000	29	80,000
	345830	50	6.3	16 x 45	367094	—	444,000	23	80,000
	356562	50	4.2	16 x 38	367094	—	444,000	18	80,000
Thickwall Polyallomer	355646	25	6.5	16 x 64	—	—	84,900	153	35,000
Thickwall Polycarbonate	355647	25	6.5	16 x 64	—	—	417,000	19	80,000

Rotor Replacement Parts

367089 Rotor Lid

Adapters/Spacers

367094



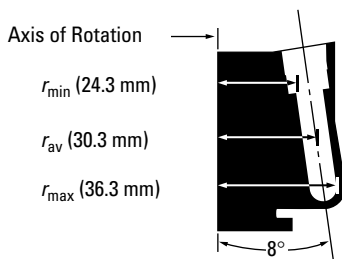

NVT™ Near-Vertical Rotor, Titanium

For use in the TL-100, Optima™ TL, Optima TLX personal micro-ultracentrifuges, and Optima MAX high-capacity personal micro-ultracentrifuges.

Note: Non-precipitating solutions up to 1.7 g/mL in density can be run in this rotor without a reduction in rotor speed.

Major applications: Plasmid DNA Separations in 1½ hours.**

Max. RPM	Max. g	k Factor	Number of Tubes Volume/Size	Rotor Capacity
120,000	585,000	7	8 x 1.2 mL 8 x 35 mm	9.6 mL



No. 357683. TLN-120 Near-Vertical Package. Includes Rotor, 1 box 361082 Quick-Seal® Polyallomer Tubes, 347402 Foam Vise Tape, 348302 Quick-Seal Tube Rack, 347373 Rotor Vise, 306812 Spinkote™ Lubricant, 12 each 347371 Plug Gaskets, 10 each 361061 Spacers, 976959 Torx Plug Adapter, 858121 Torque Wrench, and 927208 Hemostat.

Tubes and Bottles

Tube Style/Material	Part No.	Quantity	Vol. (mL)	Size (mm)	Required Caps/ Spacers (qty. 1)	Required Adapters (qty. 1)	g-Force	k factor	Max. Speed
Quick-Seal Polyallomer	361082	50	1.2	8 x 35	361061	—	585,000	7	120,000

*To accommodate the TLN-120 Rotor, the TL-100 ultracentrifuge must be updated with a new drive spindle and operating software (modification kit number 360477).
**Using Optima TLX.

Rotor Accessories

- 345529 Quick-Seal Tube Sealing Kit (60 Hz, 120 V sealer)
- 348302 Quick-Seal Tube Sealing Rack
- 358312 Quick-Seal Cordless Tube Topper Kit, 60 Hz
- 358313 Quick-Seal Cordless Tube Topper Kit, 50 Hz (Europe)
- 358314 Quick-Seal Cordless Tube Topper Kit, 50 Hz (Great Britain)
- 358315 Quick-Seal Cordless Tube Topper Kit, 50 Hz (Australia)
- 348304 Tube Topper Rack, 8 mm
- 858121 Torque Wrench
- 347960 CentriTube Slicer
- 348299 CentriTube Slicer Replacement Blades (pkg of 10)
- 338765 Tube Removal Tool
- 927208 Hemostat (6-in., curved)
- 306812 Spinkote Lubricant
- 347402 Rotor Vise Mounting Tape (replacement)
- 347404 Rotor Cleaning Brush
- 339555 Beckman Coulter Solution 555™

Rotor Replacement Parts

For Rotors Manufactured Prior to 1/2000

- 347369 Rotor Plug† (does not include gasket)
- 347371 Rotor Plug Gasket
- 347373 Rotor Vise
- 347372 Hex-plug Adapter
- 349339 Cap and Plunger Assembly

For Rotors Manufactured After 1/2000

- 368549 Rotor Plug Replacement (each)
- 368550 Rotor Plug Replacement (set of 8)
- 347371 Rotor Plug Gasket
- 347373 Rotor Vise
- 349339 Cap and Plunger Assembly
- 976959 Torx Adapter

† If replacing all rotor plugs, use Torx style, P/N 368550.

Adapters/Spacers

361061



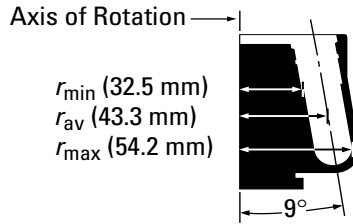

NVT™ Near-Vertical Rotor, Titanium

For use in the TL-100, Optima™ TL, Optima TLX personal micro-ultracentrifuges, and Optima MAX high-capacity personal micro-ultracentrifuges.

Note: Non-precipitating solutions up to 1.7 g/mL in density can be run in this rotor without a reduction in rotor speed.

Major applications: Plasmid DNA-Separations in 4 hours.

Max. RPM	Max. g	k Factor	Number of Tubes Volume/Size	Rotor Capacity
100,000	450,000	14	8 x 3.9 mL 13 x 38 mm	31.2 mL

No. 357614. TLN-100 Near-Vertical Rotor Package. Includes Rotor, OptiSeal™ Kit (includes 4 boxes 361627 Tubes, 8 each 362198 Spacers, 361650 OptiSeal Tube Rack, and 361668 Tube Extraction Tool), 347373 Rotor Vise, 306812 Spinkote™ Lubricant, 335148 Vacuum Grease, 12 each 342882 Sealing Washers, 976959 Torx Plug-wrench Adapter, 858121 Torque Wrench, and 927108 Hemostat.

Tubes and Bottles

Tube Style/Material	Part No.	Quantity	Vol. (mL)	Size (mm)	Required Caps/ Spacers (qty. 1)	Required Adapters (qty. 1)	g-Force	k factor	Max. Speed
OptiSeal Polyallomer	361627	56	3.3	13 x 33	362198	—	450,000	14	100,000
Quick-Seal Polyallomer	358980	50	3.9	13 x 38	342883	—	450,000	14	100,000

Rotor Accessories

- 338765 Tube Removal Tool
- 342883 Quick-Seal Tube Spacer
- 348122 Tube Topper Rack
- 858121 Torque Wrench
- 927208 Hemostats, 6-in. curved

Rotor Replacement Parts

For Rotors Manufactured Prior to 1/2000

- 342881 Rotor Plug† (gasket not included)
- 342882 Rotor Plug Gasket
- 347373 Rotor Vise
- 347402 Rotor Vise Mounting Tape (replacement)
- 349339 Cap and Plunger Assembly

For Rotors Manufactured After 1/2000

- 368545 Rotor Plug Replacement (set of 8)
- 342882 Rotor Plug Gasket
- 347373 Rotor Vise
- 347402 Rotor Vise Mounting Tape (replacement)
- 349339 Cap and Plunger Assembly
- 976959 Torx Adapter

† This part number is no longer available. If replacing all rotor plugs, use Torx style, P/N 368545.

Adapters/Spacers

342883 362198



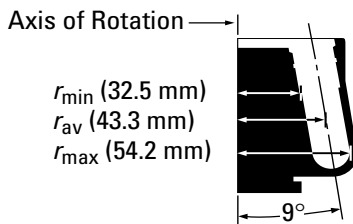

Near-Vertical Tube Rotor, Titanium

For use in the Optima™ MAX Ultracentrifuges.

Major applications: Rapid contamination-free isopycnic isolation of plasmid DNA.

Max. RPM	Max. g	k Factor	Number of Tubes Volume/Size	Rotor Capacity
80,000	389,000	20	8 x 8 mL 16 x 58 mm	64 mL



No. 367100. MLN-80 Near-Vertical Tube Rotor Package. Includes Rotor, one box of 50 each 344621 Tubes, 367101 Spacer, 348123 Tube Rack, 347373 Vise, 355875 Plug and Cell, 349290 Washer and Plug, 927208 Hemostats, 338765 Stem Lifter, 306812 Spinkote™ Lubricant and 335148 Vacuum Grease, 976595 Torx Wrench Adapter.

No. 367099. MLN-80 Near-Vertical Tube Rotor Assembly.

Tubes and Bottles

Tube Style/Material	Part No.	Quantity	Vol. (mL)	Size (mm)	Required Caps/ Spacers (qty. 1)	Required Adapters (qty. 1)	g-Force	k factor	Max. Speed
Quick-Seal® Polyallomer	344621	50	8.0	16 x 58	367101	—	390,000	20	80,000
	345830	50	6.3	16 x 45	349289 367313	—	390,000	18	80,000
	356562	50	4.2	16 x 38	349289 367312	—	390,000	16	80,000

Rotor Replacement Parts

- 355875 Plug, Cell
- 349290 Washer, Seal
- 356306 Torx Wrench Adapter

Adapters/Spacers

349289 367101 367312 367313



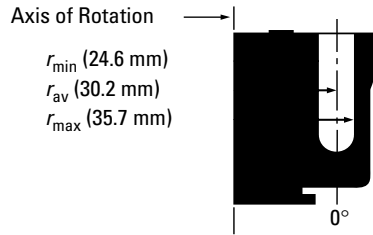

Vertical-Tube Rotor, Titanium

For use in the TL-100, Optima™ TL, Optima TLX personal micro-ultracentrifuges, and Optima MAX high-capacity personal micro-ultracentrifuges.

Note: Non-precipitating solutions up to 1.7 g/mL in density can be run in this rotor without a reduction in rotor speed.

Major application: Plasmid DNA-separations in 4 hours.

Max. RPM	Max. g	k Factor	Number of Tubes Volume/Size	Rotor Capacity
100,000	400,000	9	8 x 2.0 mL 11 x 32 mm	16 mL

No. 347375. TLV-100 Rotor Package. Includes 347374 Rotor, Spinkote™ Lubricant, Removal Tool, Washers, Wrench Assembly, Torque Wrench, Vise and Tape, box of 344625 Tubes, 349487 Quick-Seal® Tube Rack, Adapters, and Spacers.

Tubes and Bottles

Tube Style/Material	Part No.	Quantity	Vol. (mL)	Size (mm)	Required Caps/ Spacers (qty. 1)	Required Adapters (qty. 1)	g-Force	k factor	Max. Speed
Quick-Seal Polyallomer	344625	50	2.0	11 x 32	347370	—	400,000	9	100,000

Rotor Accessories

- 349487 Tube Rack for 11-mm Tubes (included with Rotor Package)
- 362101 Tube Rack Adapter for sealing 11 x 32 mm Tubes in Tube Rack 349487
- 347373 Rotor Vise
- 347402 Foam Vise Mounting Tape
- 347404 Rotor Cleaning Brush
- 858121 Torque Wrench
- 927208 Hemostats

Rotor Replacement Parts

For Rotors Manufactured Prior to 1/2000

- 347369 Rotor Plug† (does not include gasket)
- 347371 Rotor Plug Gasket
- 347370 Quick-Seal Tube Spacers
- 347372 Hex-plug Adapter for Torque Wrench
- 349339 Cap and Plunger Assembly

For Rotors Manufactured After 1/2000

- 368549 Rotor Plug Replacement (each)
- 368550 Rotor Plug Replacement (set of 8)
- 347371 Rotor Plug Gasket
- 347370 Quick-Seal Tube Spacers
- 349339 Cap and Plunger Assembly
- 976959 Torx Adapter

† If replacing all rotor plugs, use Torx style, P/N 368550.

Adapters/Spacers

347370



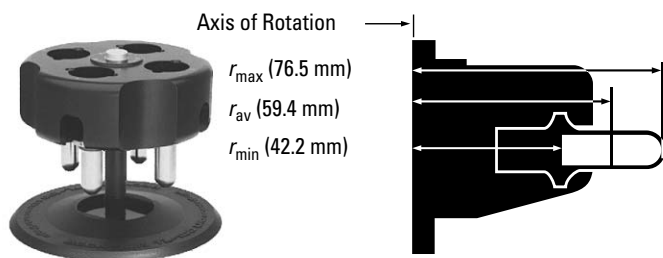

Swinging-Bucket Rotor, Titanium

For use in the TL-100, Optima™ TL, Optima TLX personal micro-ultracentrifuges, and Optima MAX high-capacity personal micro-ultracentrifuges.

Note: Non-precipitating solutions up to 1.7 g/mL in density can be run in this rotor without a reduction in rotor speed.

Major applications: RNA pelleting in 2-3 hours; subcellular fractionation in sucrose gradients, protein separations in sucrose gradients.

Max. RPM	Max. g	k Factor	Number of Tubes Volume/Size	Rotor Capacity
55,000	259,000	50	4 x 2.2 mL 11 x 34 mm	8.8 mL



No. 346936. TLS-55 Swinging-Bucket Rotor Assembly with 4 Titanium Buckets.

No. 346134. TLS-55 Swinging-Bucket Rotor Package. Includes Rotor, 348305 Tube Rack, 1 Box of 347357 Polyallomer Tubes, 868638 Set of 4 O-rings, 927208 Hemostats, 347358 Bucket Holder Rack, 335148 Vacuum Grease, and 306812 Spinkote™ Lubricant.

Tubes and Bottles

Tube Style/Material	Part No.	Quantity	Vol. (mL)	Size (mm)	Required Caps/ Spacers (qty. 1)	Required Adapters (qty. 1)	g-Force	k factor	Max. Speed
Quick-Seal® Polyallomer	344625	50	2.0	11 x 32	344674	—	259,000	50	55,000
	344624	50	1.5	11 x 25	344674	—	259,000	37	55,000
Thinwall Polyallomer	347357	50	2.2	11 x 34	—	—	259,000	50	55,000
	342630	100	175 µL	5 x 20	—	358614	248,000	22	55,000
Thickwall Polyallomer	347287	100	1.4	11 x 34	—	—	259,000	50	55,000
Thickwall Polycarbonate	343778	100	1.4	11 x 34	—	—	259,000	50	55,000
	343775	100	230 µL	7 x 20	—	358615	249,000	23	55,000
Thinwall Cellulose Propionate	342630	100	175 µL	5 x 20	—	358614	248,000	22	55,000
Thickwall Cellulose Propionate	342303	100	230 µL	7 x 20	—	358615	249,000	23	55,000
Thickwall Polyethylene	343622	100	175 µL	5 x 20	—	358614	248,000	22	55,000
Thinwall Ultra-Clear	347356	50	2.2	11 x 34	—	—	259,000	50	55,000

Rotor Accessories

- 348305 Tube Rack for 11-mm Tubes (included with Rotor Package)
- 349487 Quick-Seal Tube Rack (Tube Rack Adapters required)
- 362100 Tube Rack Adapters, set/8, for 344624 11 x 25 mm Quick-Seal Tubes
- 362101 Tube Rack Adapters, set/8, for 344625 11 x 25 mm Quick-Seal Tubes
- 349387 Tube Topper Rack for 11-mm Tubes
- 927208 Hemostats, 6-in. curved
- 347404 Rotor Cleaning Brush

Rotor Replacement Parts

- 345773 Rotor Stand
- 346364 Replacement Bucket Set, set of 4
- 868638 Bucket O-ring, set of 4
- 345770 Bucket Cap Assembly (each)
- 347358 Bucket Stand
- 349338 Cap & Plunger Assembly

Adapters/Spacers

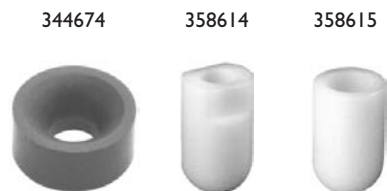

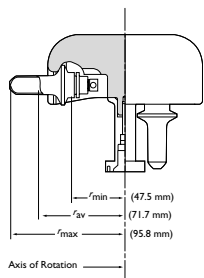

Swinging-Bucket Rotor, Aluminum

For use in the Optima™ MAX Ultracentrifuges.

Major applications: Rate-zonal separations of subcellular organelles, pelleting and isopycnic separations of RNA.

Max. RPM	Max. g	k Factor	Number of Tubes Volume/Size	Rotor Capacity
50,000	268,000	71	4 x 5 mL 13 x 51 mm	20 mL

No. 367280. MLS-50 Swinging-Bucket Rotor Package. Includes Rotor, one box of 326819 Polyallomer Tubes, 331313 Rack Assembly, 824412 O-ring, 927208 Hemostats, 306812 Spinkote™ Lubricant and 335148 Vacuum Grease.

No. 367279. MLS-50 Swinging-Bucket Rotor Assembly.

Tubes

Tube Style/Material	Part No.	Quantity	Vol. (mL)	Size (mm)	Floating Spacers (qty. 1)	Adapters (qty. 1)	g-Force	k Factor	Max. Speed
OptiSeal™ Polyallomer	361627	50	3.3	13 x 33	361678*	—	268,000	42	50,000
Quick-Seal® Polyallomer	345829	50	2.0	13 x 25	355535	—	268,000	29	50,000
Quick-Seal konical™ Polyallomer	358647	50	3.2	13 x 51	355535	358153**	262,000	67	50,000
Polyallomer	326819	50	5.0	13 x 51	—	—	268,000	71	50,000
konical Polyallomer	358119	50	3.0	13 x 51	—	358153**	262,000	67	50,000
Thickwall Polyallomer	349623	25	3.5	13 x 51	—	—	268,000	71	50,000
Thickwall Polycarbonate	349622	25	3.5	13 x 51	—	—	268,000	71	50,000
Ultra-Clear	344057	50	5.0	13 x 51	—	—	268,000	71	50,000
	344090	50	0.8	5 x 41	—	356860	218,000	67	46,000

* Package of two.

** Package of six.

Rotor Replacement Parts

- 367278 Rotor Stand Assembly
- 367284 Bucket Set
- 367285 Bucket Cap
- 824412 O-ring

Adapters/Spacers

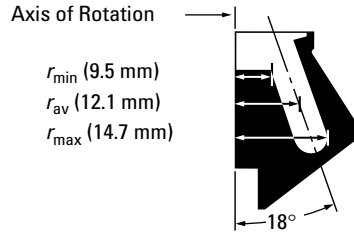

**Fixed-Angle Rotor, Aluminum, Red**

For use in the Airfuge® Air-Driven Micro-Ultracentrifuge.
Major application: Fast pelleting of very small samples.

Max. RPM	Max. g	k Factor	Number of Tubes Volume/Size	Rotor Capacity
110,000	199,000	9	6 × 180 µL 5 × 20 mm	1,080 µL

No. 347596. A-110 Rotor. Fixed-Angle Rotor with 18° angle, aluminum, anodized red. Includes 1 box of 342630 polyallomer tubes.

 Tubes and Bottles

Tube Style/Material	Part No.	Quantity	Usable Volume	Size (µL)	g-Force (mm)	k Factor	Max. Speed
Open-Top Tubes							
Polyallomer	342630	100	175	5 × 20	199,000	9	110,000
Polyethylene	343622	100	175	5 × 20	199,000	9	110,000
Ultra-Clear™	344718	100	180	5 × 20	199,000	9	110,000

 Rotor Supplies

339643 Rotor Caps, polyethylene, package of 20
348301 Tube Rack for 5-mm diameter Tubes
343773 Tube Cap Strip, 6-place, package of 50
339639 Rotor Base Bushing, white
341252 Rotor Stand/Vise

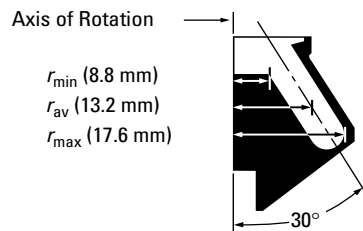
**Fixed-Angle Rotor, Aluminum, Blue**

For use in Airfuge® Air-Driven Micro-Ultracentrifuge.
Major application: Fast pelleting of very small samples.

Max. RPM	Max. g	k Factor	Number of Tubes Volume/Size	Rotor Capacity
92,000	167,000	19	6 × 240 µL 5 × 20 mm	1,440 µL

No. 347594. A-100/30 Rotor. Fixed-Angle Rotor with 30° angle, anodized blue. Includes 1 box of 342630 Polyallomer Tubes.

 Tubes and Bottles

Tube Style/Material	Part No.	Quantity	Usable Volume	Size (µL)	g-Force (mm)	k Factor	Max. Speed
Open-Top Tubes							
Polyallomer	342630	100	220	5 × 20	167,000	19	92,000
Polyethylene	343622	100	150	5 × 20	167,000	19	92,000
Ultra-Clear™	344718	100	240	5 × 20	167,000	19	92,000

 Rotor Supplies

339643 Rotor Caps, polyethylene, package of 20
348301 Tube Rack for 5-mm diameter Tubes
343773 Tube Cap Strip, 6-place, package of 50
341252 Rotor Stand/Vise

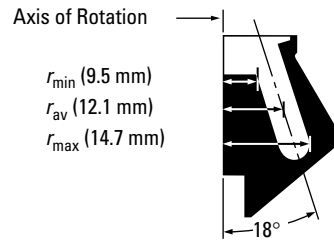
**Fixed-Angle Rotor, Aluminum, Silver**

For use in the Airfuge Air-Driven Micro-Ultracentrifuge.
Major application: Fast pelleting of very small samples.

Max. RPM	Max. g	k Factor	Number of Tubes Volume/Size	Rotor Capacity
95,000	148,000	12	6 × 175 µL 5 × 20 mm	1,050 µL

No. 347593. A-100/18 Rotor. Fixed-Angle Rotor with 18° angle, aluminum, anodized silver. Includes 1 box of 342630 Polyallomer Tubes.

Tubes and Bottles

Tube Style/Material	Part No.	Quantity	Usable Volume (µL)	Size (mm)	g-Force	k Factor	Max. Speed
Open-Top Tubes							
Polyallomer	342630	100	175	5 × 20	148,000	12	95,000
Polyethylene	343622	100	100	5 × 20	148,000	12	95,000
Ultra-Clear	344718	100	175	5 × 20	148,000	12	95,000

Rotor Supplies

339643 Rotor Caps, polyethylene, package of 20
348301 Tube Rack for 5-mm diameter tubes
343773 Tube Cap Strip, 6-place, package of 50
339639 Rotor Base Bushing, white
341252 Rotor Stand/Vise

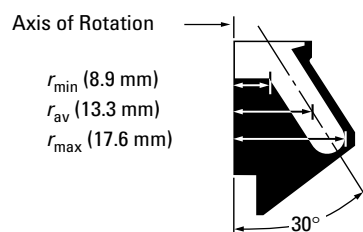
**Fixed-Angle Rotor, Aluminum, Black**

For use in Airfuge Air-Driven Micro-Ultracentrifuge.
Major application: Fast pelleting of very small samples.

Max. RPM	Max. g	k Factor	Number of Tubes Volume/Size	Rotor Capacity
95,000	178,000	19	4 × 450 µL 8 × 20 mm	1,800 µL

No. 347595. A-95 Rotor. Fixed-Angle Rotor with 30° angle, aluminum, anodized black. Includes 1 box of 345843 Ultra-Clear™ Tubes.

Tubes and Bottles

Tube Style/Material	Part No.	Quantity	Usable Volume	Size (µL)	g-Force (mm)	k Factor	Max. Speed
Open-Top Tubes							
Ultra-Clear	345843	100	450	8 × 20	178,000	19	95,000

Rotor Supplies

339643 Rotor Caps, polyethylene, package of 20
348304 Tube Rack for 8-mm diameter Tubes
343773 Tube Cap Strip, 6-place, package of 50
339639 Rotor Base Bushing, white
341252 Rotor Stand/Vise



ACR-90 Chylomicron Rotor, Silver

For use in the Airfuge Air-Driven Micro-Ultracentrifuge.
Major application: Rapid clarification of lipemic blood samples.

Max. RPM	Max. g	k Factor	Rotor Capacity Volume/Size	Yield (mL)
90,000	122,000	45	3.5 mL	2.6
90,000	107,000	39	2.4 mL	1.4

No. 341260. ACR-90 Chylomicron Rotor, anodized aluminum. Consists of a Supporting Base, a Disposable Polyethylene Liner, and Stainless Steel Lid. Includes Rotor Stand/Vise, one package 341251 Liners, Adapter for 342634 Liner.

Rotor Supplies

- 341251 Liner, polyethylene, 3.5 mL capacity, package of 100
- 342634 Liner, polyethylene, 2.4 mL capacity, package of 100 (Adapter required)
- 342635 Adapter for 342634 Liners, reusable
- 343779 Disposable Loading and Unloading Pipette, package of 500
- 339639 Rotor Bushing, white
- 341252 Rotor Stand/Vise
- 306812 Spinkote™ Lubricant



Batch Rotor, Aluminum, Silver

For use in the Airfuge® Air-Driven Micro-Ultracentrifuge.
Major application: Rapid processing of fruit paste.

Max. RPM	Max. g	Minimum Fill Volume	Maximum Fill Volume	k Factor
90,000	132,000	2 mL	7 mL 8 at 2 mL	55 at 7 mL

No. 347833. Batch Rotor, aluminum, for 2- to 7-mL volumes. Sample is placed in the rotor body itself or in one of two types of polyethylene liners. A plastic window disk is placed between the rotor and the lid to contain samples during centrifugation. Includes Rotor Stand/Vise and one each 853156 O-ring, 343197 Bushing.

Rotor Supplies

- 343130 Shell Liner, polyethylene, large opening, 7-mL capacity, package of 100
- 343132 Dome Liner, polyethylene, small opening, 7-mL capacity, package of 100
- 347049 Rotor Window Disk
- 853156 Rotor O-ring
- 343197 Bushing, red



EM-90 Particle Counting Rotor, Silver

For use in the Airfuge® Air-Driven Micro-Ultracentrifuge.

Major applications: Sedimenting particles onto filter membranes, glass cover slides, and microscope grids.

Max. RPM	Max. g	Maximum Volume	Rotor Capacity
90,000	118,000	6 × 100 µL	600 µL

1

No. 347844. EM-90 Electron Microscopy Particle Counting Rotor. Includes 5-mm Core with 600 µL capacity (100 µL per cell); 3-mm Core with 360 µL capacity (60 µL per cell); Rotor Stand/Vise, Gaskets, Sector Core Removal Bolt, Template, one 853156 O-ring, one 343197 Bushing.

Rotor Supplies

- 347838 Sector Core, 3 mm
- 347836 Sector Core, 5 mm
- 347840 Rotor Gaskets, package of 5
- 343197 Bushing, red

